

# C4 (1964 - 1981)

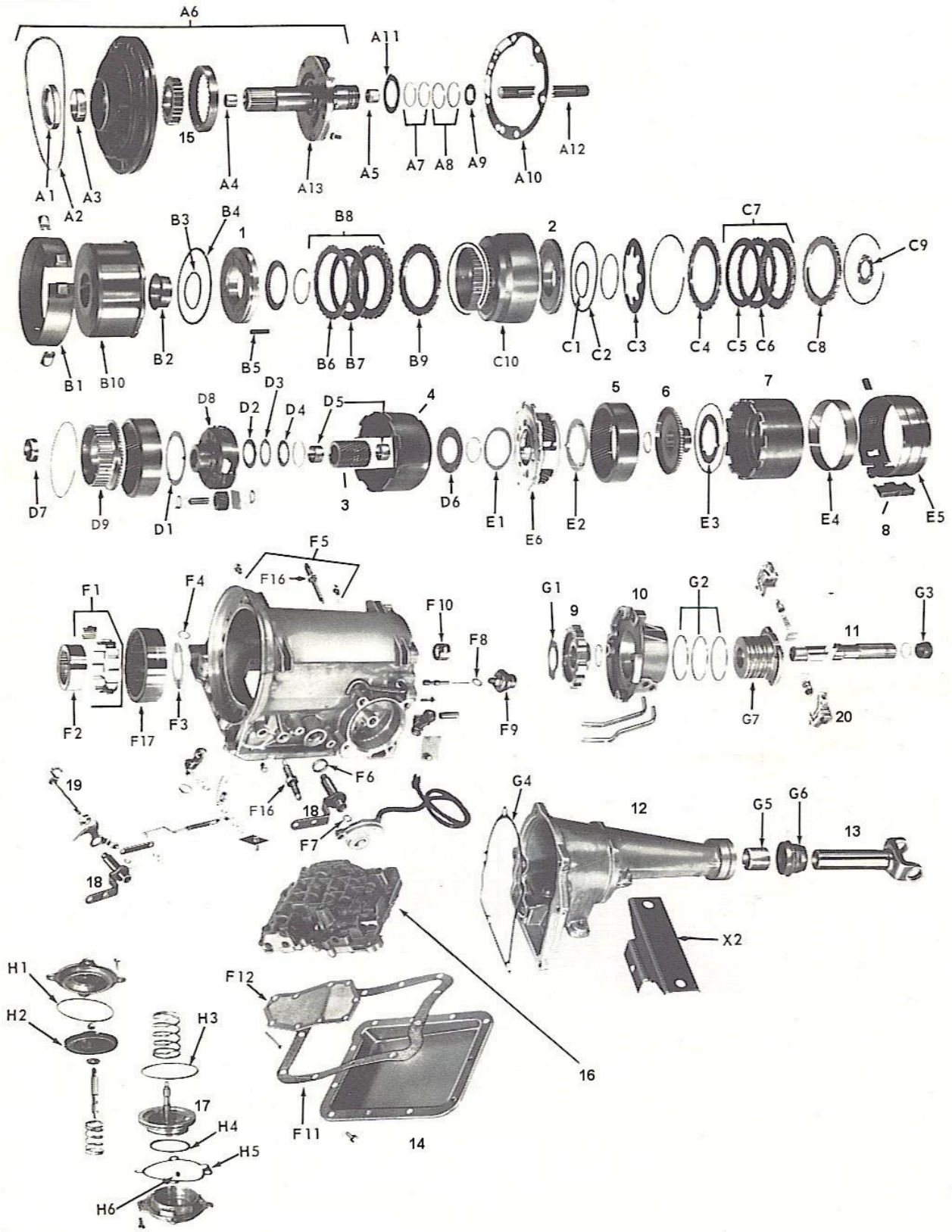

**FORD**

**C4, C5**

ILL	DESCRIPTION	YEARS	QTY	FATSCO	REFERENCE
-----	-------------	-------	-----	--------	-----------

**REBUILDING KITS**

DESCRIPTION	YEARS	MASTER KIT	MAJOR KIT	OVERHAUL KIT	PAPER/RUBBER
C4 .....	1964	137-KX	237-KX	339-KX	
C4 .....	65-69	138-KX	238-KX	339-KX	541-KX
C4 .....	70-81	191-KX	291-KX	3412-KX	579-KX
C5 .....	82-86	147-UX	247-UX	3403-UX	545-UX
<b>HI-PERFORMANCE</b>					
C4 - standard steels .....	65-69	1516-KX	2516-KX	339-KX	541-KX
C4 - Kolene® steels .....	65-69	1517-KX	2516-KX	339-KX	541-KX
C4 - standard steels .....	70-81	1518-KX	2518-KX	3412-KX	579-KX
C4 - Kolene® steels .....	70-81	1519-KX	2518-KX	3412-KX	579-KX

**VALVE BODY KITS**

NI	Shift Kit® .....	65-66	1	<b>SFK-4L</b>	SK®4L
	.....	1967	1	<b>SFK-4S</b>	SK®4S
	.....	68-69	1	<b>SFK-4SL</b>	SK®4SL
	.....	70-72	1	<b>SFK-71</b>	SK®71
	- C4 & C5 .....	73-86	1	<b>SFK-C5</b>	SK®C5
NI	Reprogramming Kit™ - Tow & Go .....	65-66	1	<b>SFK-451</b>	45-01
	- Tow & Go .....	67-69	1	<b>SFK-471</b>	47-1
	- Tow & Go .....	67-69	1	<b>SFK-472</b>	47-2
	- Tow & Go .....	70-81	1	<b>SFK-402</b>	40-2
NI	Reprogramming Kit™ - manual shift .....	67-69	1	<b>SFK-473</b>	47-3
	- manual shift .....	70-81	1	<b>SFK-403</b>	40-3

**CLUTCH PLATES**

<b>FRICION PLATES</b>					
C5	Forward - .061" .....	64-86	4-5	<b>1332-K</b>	C8AZ-7B164D
	- .061" - hi-performance .....	64-86	4-5	<b>1668-K</b>	
B7	Direct - .090" .....	1964	3-4	<b>1233-K</b>	C4AZ-7B164D
	- .078" .....	65-86	3-4	<b>1331-K</b>	C5AZ-7B164B
	- .078" - hi-performance .....	65-86	3-4	<b>1669-K</b>	
<b>STEEL PLATES</b>					
C6	Forward - .078" - dull finish .....	64-67	3-4	<b>1231-K</b>	C4AZ-7B442C
	- .078" .....	68-86	3-4	<b>1230-K</b>	C4AZ-7B442B
	- .095" - oversized .....	64-86	ar	<b>1287-K</b>	
	- .078" - Kolene® .....	64-86	3-4	<b>1670-K</b>	
B6	Direct - .078" .....	64-81	3-4	<b>1230-K</b>	C4AZ-7B442B
	- .090" - C5 .....	82-86	3-4	<b>1196-U</b>	E2SZ-7B442A
	- .095" - oversized .....	64-86	ar	<b>1287-K</b>	
	- .078" - Kolene® .....	64-86	3-4	<b>1670-K</b>	

**PRESSURE PLATES**

C8	Forward - .220" - flat .....	65-81	1	<b>8626-K</b>	C5AZ-7B066D
C4	- .267" - beveled .....	64-81	1	<b>8671-K</b>	C8AZ-7B066C
	- .313" - beveled .....	81-86	1	<b>26307E</b>	E1AZ-7B066A
B9	Direct - .220" .....	64-81	1	<b>8626-K</b>	C4AZ-7B066A
	- .141" .....	81-86	1	<b>26307F</b>	E1AZ-7B066B
	- .297" .....	82-86	1	<b>26307G</b>	E2SZ-7B066B

### GASKETS

F11	Oil Pan - fiber .....	64-86	1	<b>2423-K</b>	D6OZ-7A191A
	- cork & rubber .....	64-86	1	<b>2423-KCR</b>	D6OZ-7A191A
A10	Front Pump to Case .....	64-86	1	<b>2421-K</b>	E1AZ-7A136A
NI	3-2 Timing Body - C5 .....	82-86	1	<b>2742-U</b>	E2DZ-7F497A
NI	Valve Body .....	1964	1	<b>2420-K</b>	C4AZ-7D100B
	.....	65-66	1	<b>2098-K</b>	C5AZ-7D100B
	.....	67-69	1	<b>2579-K</b>	C9AZ-7D100A
	- L6 & V8 .....	70-81	1	<b>2607-K</b>	D4OZ-7D100A
	- 4 cyl. & V6 .....	70-81	1	<b>2623-K</b>	D4FZ-7D100B
	- C5 .....	82-86	1	<b>2741-U</b>	E3DZ-7D100A
H5	Intermediate Servo Cover .....	64-86	1	<b>2418-K</b>	C4AZ-7D026C
F8	Vacuum Modulator - screw in .....	64-71	1	<b>2514-F</b>	C1AP-7B426A
G4	Extension Housing .....	64-86	1	<b>2419-K</b>	C4AZ-7086C
NI	Filter to Valve Body - deep pan only - metal .....	64-82	1	<b>2099-K</b>	D3BZ-7E062A

### O'RINGS & RUBBER SEALS

A2	LCS, Front Pump to Case .....	64-66	1	<b>4711-K</b>	376950-S
NI	LCS, Intermediate Servo Cover .....	64-86	1	<b>4703-K</b>	C4AZ-7D024B
	LCS, Intermediate Servo - large - 3.390" ID .....	64-81	1	<b>4184-K</b>	D5TZ-7D024A
	- 2.807" ID .....	70-77	1	<b>4829-K</b>	DOAZ-7D024A
	- 2.867" ID .....	72-81	1	<b>4185-K</b>	D2DZ-7D024A
	- 3.273" OD .....	64-81	1	<b>4732-K</b>	C5ZZ-7D024A
	- 3.352" OD .....	64-77	1	<b>4703-K</b>	C4AZ-7D024B
	- 3.625" OD .....	64-77	1	<b>4704-K</b>	C4AZ-7D024A
	O'ring, Intermediate Servo - large - 3.487" ID .....	82-86	1	<b>4729-U</b>	E1AZ-7D024A
	LCS, Intermediate Servo - small - 1.823" ID .....	65-70	1	<b>4733-K</b>	C5DZ-7D025A
	- 1.945" ID .....	65-74	1	<b>4758-K</b>	C5ZZ-7D025A
	- 2.060" ID .....	64-77	1	<b>4706-K</b>	C4DZ-7D025A
	- 2.271" ID .....	64-81	1	<b>4186-K</b>	D9FZ-7D025A
	- 2.381" ID .....	64-81	1	<b>4875-K</b>	D9AZ-7D025A
	- 2.505" ID .....	64-81	1	<b>4189-K</b>	D5TZ-7D025A
	- 2.687" ID .....	65-68	1	<b>4757-K</b>	C5AZ-7D025A
	- 3.000" OD .....	64-81	1	<b>4760-K</b>	C8ZZ-7D025A
	- 2.733" OD .....	64-81	1	<b>4707-K</b>	C4OZ-7D025A
	- 2.875" OD .....	64-79	1	<b>4705-K</b>	C4AZ-7D025B
	O'ring, Intermediate Servo - small - 2.550" ID .....	82-86	1	<b>4191-K</b>	E1AZ-7D025A
	- 2.237" ID .....	82-86	1	<b>4745-U</b>	E2SZ-7D025A
	- 2.362" ID .....	82-86	1	<b>4731-U</b>	E2DZ-7D025A

**FORD**

**C4, C5**

ILL	DESCRIPTION	YEARS	QTY	FATSCO	REFERENCE
H1	LCS, Reverse Servo Cover .....	64-69	1	<b>4708-K</b>	C4AZ-7D404A
	.....	70-86	1	<b>4190-K</b>	DOAZ-7D040A
NI	Ball, Valve Body Check .....	64-86	2-4	<b>9272-K</b>	C7AZ-7E195A
	O'ring, Oil Filler Tube .....	64-86	1	<b>4702-BC</b>	87034-S94
	O'ring, Throttle Control Lever .....	64-86	1	<b>4617-F</b>	386078-S
	Lobed Seal, Throttle Control Lever - repl. above .	64-86	opt	<b>4066-AD</b>	386078-S
NI	O'ring, Speedometer .....	64-86	1	<b>4676-Z</b>	87036-S94
	O'ring, Vacuum Modulator .....	72-86	1	<b>4617-F</b>	386078-S
	Hose, Vacuum Modulator .....	64-86	1	<b>8155-K</b>	C1AZ-7B087E
NI	O'ring, Oil Cooler Tubes .....	65-86	4	<b>4759-S</b>	380892-S94
	Check Valve - Int. Servo Accum - rubber .....	64-80	1	<b>9268-K</b>	C5AZ-7D376A
	Check Valve - Int. Servo Accum - plastic .....	81-86	1	<b>4192-K</b>	D9AZ-7D376A
	Grommet, Shift Cable - plastic .....	67-86	1	<b>9293-F</b>	D4AZ-7341A
<b>CLUTCH PISTON SEALS</b>					
C1	O'ring, Forward Clutch - inner .....	64-70	1	<b>4653-F</b>	B5AZ-7A294E
	.....	70-86	1	<b>4830-K</b>	DOAZ-7A294A
C2	LCS, Forward Clutch - outer .....	64-79	1	<b>4710-K</b>	C4AZ-7A548C
	Lip Seal, Forward Clutch - outer .....	79-86	1	<b>4967-K</b>	D8OZ-7A548A
B3	O'ring, Direct Clutch - inner .....	64-67	1	<b>4653-F</b>	B5AZ-7A294E
	LCS, Direct Clutch - inner .....	68-69	1	<b>4792-K</b>	C8AZ-7D404B
	.....	70-86	1	<b>4831-K</b>	DOAZ-7D404A
B4	LCS, Direct Clutch - outer .....	64-81	1	<b>4709-K</b>	C8AZ-7A548B
	Lip Seal, Direct Clutch - outer .....	82-86	1	<b>4923-U</b>	E1AZ-7A548A
<b>MOLDED PISTONS</b>					
H2	Reverse Servo Piston .....	64-86	1	<b>8609-K</b>	D1AZ-7D189A
<b>METAL CLAD SEALS</b>					
A1	Front Pump - w/o flange .....	64-86	1	<b>3177-S</b>	C2AZ-7A248A
	- w/flange .....	64-86	ar	<b>3119-F</b>	C3OP-7A248A
G6	Extension Housing - w/flange .....	64-86	1	<b>3146-D</b>	D5AZ-7052B
	- w/o flange .....	64-86	ar	<b>3147-G</b>	D5AZ-7052B
	- w/bolt on yolk .....	64-72	1	<b>3136-K</b>	C4UZ-7052A
	- w/long boot .....	64-86	ar	<b>3217-F</b>	D5AZ-7052B
	- w/short boot .....	64-86	ar	<b>3139-K</b>	D5AZ-7052B
F6	Manual Lever Shaft .....	64-86	1	<b>3150-F</b>	D5AZ-7B496A
<b>BUSHINGS</b>					
NI	Bushing Kit .....	64-69	1	<b>5045-KX</b>	
	.....	70-86	1	<b>5003-KX</b>	
A3	Front Pump Body - bronze .....	64-86	1	<b>5199-S</b>	COAP-7B258A
	- babbitt .....	64-86	1	<b>5490-K</b>	COAP-7B258A
A4	Stator Support - front .....	64-69	1	<b>5289-K</b>	C4AZ-7B261A
	.....	70-86	1	<b>5342-K</b>	DOAZ-7B261A
A5	Stator Support - rear .....	64-69	1	<b>5290-K</b>	C4AZ-7D018B

		70-86	1	<b>5343-K</b>	DOAZ-7D018A
B2	Direct Drum .....	64-69	1	<b>5291-K</b>	C4AZ-7D046A
	Direct Drum .....	70-86	1	<b>5344-K</b>	DOAP-7D046B
D7	Forward Clutch Hub .....	66-86	1	<b>5318-K</b>	C6AZ-7E059A
D5	Sun Gear .....	64-86	2	<b>5292-K</b>	C4AZ-7D065A
E4	Reverse Brake Drum .....	64-86	1	<b>5293-K</b>	C4AZ-7D001A
F10	Case .....	64-86	1	<b>5294-K</b>	C4AZ-7025A
G5	Extension Housing .....	64-86	1	<b>5060-F</b>	B3TZ-7A034A
	- bearing .....	64-86	1	<b>52100-K</b>	C3AZ-7025B

### WASHERS, BEARINGS, RACES & SHIMS

<b>KITS</b>					
NI	Washer Kit - less selectives .....	64-86	1	<b>6075-KX</b>	
	- front pump selective .....	64-66	1	<b>6077-KX</b>	
	- front pump selective .....	67-86	1	<b>6087-KX</b>	
	- forward clutch selective .....	70-on	1	<b>6066-KX</b>	
	- forward clutch selective .....	64-69	1	<b>6078-KX</b>	
	- rear sun gear .....	64-86	1	<b>6063-KX</b>	
<b>WASHERS &amp; SHIMS</b>					
A11	Front Pump - w/o tangs - .040" .....	64-66	sel	<b>6550-K</b>	C4AZ-7D014A
	- w/o tangs - .050" .....	64-66	sel	<b>6551-K</b>	C4AZ-7D014B
	- w/o tangs - .072" .....	64-66	sel	<b>6552-K</b>	C4AZ-7D014C
	- w/o tangs - .089" .....	64-66	sel	<b>6553-K</b>	C4AZ-7D014D
	- w/o tangs - .106" .....	64-66	sel	<b>6554-K</b>	C4AZ-7D014E
	- w/tangs - .072" - green .....	67-86	sel	<b>6583-K</b>	DOAZ-7D014A
	- w/tangs - .089" - natural .....	67-86	sel	<b>6584-K</b>	DOAZ-7D014B
	- w/tangs - .106" - black .....	67-86	sel	<b>6585-K</b>	DOAZ-7D014C
	- w/tangs - .123" - yellow .....	67-86	sel	<b>6586-K</b>	DOAZ-7D014D
	- w/tangs - .140" - blue .....	67-86	sel	<b>6231-K</b>	DOAZ-7D014E
	- .020" - shim .....	66-86	sel	<b>6943-K</b>	
	- .030" - shim .....	66-86	sel	<b>6240-K</b>	
D1	Forward Clutch Hub to Front Planetary .....	64-71	1	<b>6549-K</b>	C4AZ-7A242A
C9	Forward Hub to Ring Gear - 3 tab .....	64-69	1	<b>6494-K</b>	C4AZ-7D090A
	- 3 tab .....	70-86	1	<b>6592-K</b>	DOAZ-7D090A
D6	Input Shell .....	64-86	1	<b>6242-K</b>	C4AZ-7D066B
D1/E1	Forward & Reverse Planetary .....	64-71	2	<b>6549-K</b>	C4AZ-7A242A
	- 3 inner tabs .....	72-86	2	<b>6733-K</b>	D2OZ-7A242A
E3	Reverse Drum to Rear Ring Gear .....	64-79	1	<b>6548-K</b>	C4AZ-7C096A
	.....	80-86	2	<b>6243-K</b>	EOAZ-7C098B
G1	Parking Gear - 3 external slots .....	64-86	1	<b>6236-K</b>	C4AZ-7B368A
F3	Reverse Drum to Case .....	64-86	1	<b>6511-K</b>	EOAZ-7D072A
A9	Forward Clutch - .042" .....	70-86	sel	<b>6734-K</b>	DOAZ-7D091A
	- .057" .....	70-86	sel	<b>6735-K</b>	DOAZ-7D091B
	- .074" .....	70-86	sel	<b>3736-K</b>	DOAZ-7D091C
	- .042" .....	64-69	sel	<b>6512-K</b>	C4AZ-7D091A
	- .057" .....	64-69	sel	<b>6513-K</b>	C4AZ-7D091B

FORD

**C4, C5**

ILL	DESCRIPTION	YEARS	QTY	FATSCO	REFERENCE
	- .074" .....	64-69	sel	<b>6514-K</b>	C4AZ-7D091C
	- .091" .....	64-69	sel	<b>6515-K</b>	C4AZ-7D091E
	- .015" - shim .....	64-86	sel	<b>6732-K</b>	
	- .020" - shim .....	64-86	sel	<b>6245-K</b>	
	- .030" - shim .....	64-86	sel	<b>6246-K</b>	
	<b>BEARINGS &amp; RACES</b>				
	Rear Sun Gear - 1pc type .....	64-86	1	<b>6705-K</b>	
	Bearing, Rear Sun Gear Needle .....	64-86	1	<b>6493-K</b>	C4AZ-7D234A
	Race, Rear Sun Gear Bearing - front .....	64-86	1	<b>6492-K</b>	C4AZ-7D236A
	Race, Rear Sun Gear Bearing - rear .....	64-86	1	<b>6491-K</b>	C4AZ-7D235A
<b>SEALING RINGS</b>					
NI	Sealing Ring Kit - C4 .....	64-69	1	<b>7056-KX</b>	
	- C4 & C5 .....	70-86	1	<b>7074-KX</b>	
	Stator Support to Forward Drum .....	64-69	2	<b>7266-K</b>	C4AZ-7D019B
	- .093" - metal ..	70-77	2	<b>7305-K</b>	DOAZ-7A019A
	- .125" - metal ..	78-86	2	<b>7308-K</b>	D7AZ-7D019A
	- .125" - Teflon .	78-86	2	<b>7308-KT</b>	D7AZ-7D019A
	Stator Support to Direct Drum .....	64-69	2	<b>7267-K</b>	C4AZ-7D020A
	- metal .....	70-86	2	<b>7306-K</b>	DOAZ-7D020A
	- Teflon .....	70-86	2	<b>7306-KT</b>	DOAZ-7D020A
	Governor Housing - metal .....	64-86	3	<b>7265-K</b>	C4AZ-7D011A
	- Teflon .....	64-86	3	<b>7265-KT</b>	C4AZ-7D011A
<b>FILTERS</b>					
F12	Filter - C4 .....	1964	1	<b>847-K</b>	C4AZ-7A098B
	- C4 .....	65-70	1	<b>895-K</b>	C5AZ-7A098C
	- C4 .....	70-81	1	<b>894-K</b>	DODZ-7A098B
	- C4 - Dacron - high filtration .....	70-81	1	<b>815-K</b>	
	- C4 - deep pan - Mustang II & Pinto .....	74-81	1	<b>883-K</b>	D4FZ-7A098A
	- C4 - Bronco .....	73-77	1	<b>885-K</b>	D3BZ-7A098A
	- C5 - 2WD .....	82-86	1	<b>ST-30</b>	E2DZ-7A098A
	- C5 - 4WD .....	83-86	1	<b>ST-33</b>	E3TZ-7A098A
	Governor Screen .....	67-86	1	<b>850-K</b>	C7AZ-7E242E
NI	Filter Kit - C4 .....	1964	1	<b>763-KX</b>	
	- C4 .....	65-70	1	<b>762-KX</b>	
	- C4 .....	70-81	1	<b>761-KX</b>	
	- C4 - Dacron - high filtration .....	70-81	1	<b>470-KX</b>	
	- C4 - deep pan - Mustang II & Pinto .....	74-81	1	<b>733-KX</b>	
	- C4 - Bronco .....	73-77	1	<b>732-KX</b>	
	- C5 - 2WD .....	82-86	1	<b>740UX</b>	
	- C5 - 4WD .....	83-86	1	<b>730-UX</b>	

## BANDS

B1	Intermediate Band - 1.28" - solid .....	1964	1	<b>BT-41</b>	C4AZ-7D034C
	- 2.10" - solid .....	65-71	1	<b>BT-44</b>	C5AZ-7D034A
	- flex .....	65-86	1	<b>BT-49</b>	D9AZ-7D034C
	- snap in .....	65-86	1	<b>BT-18</b>	
E5	Reverse Band .....	64-86	1	<b>BT-42</b>	DOAZ-7D095A
F5	Band Adjusting Nut - coarse thread .....	64-86	1-2	<b>9278-K</b>	380850-S
	- C5 front - fine thread .....	81-86	1	<b>9282-K</b>	389049-S
NI	Strut, Front Flex Band .....	65-86	1-2	<b>9518-K</b>	-

## MODULATORS

F9	Modulator - single diaphragm:				
	- screw in - white/green - adjustable .....	64-72	1	<b>MT-63</b>	C4AZ-7A377B
	- push in - yellow .....	72-81	1	<b>MT-44</b>	D2AZ-7A377-A
	- push in - yellow - adjustable .....	72-81	1	<b>MT-91</b>	D2AZ-7A377-A
	- push in - green - adjustable .....	75-81	1	<b>MT30</b>	D5AZ-7A377B
	- push in - white - adjustable .....	82-86	1	<b>MT-14</b>	E2TZ-7A377A
	Vacuum Modulator - dual diaphragm:				
	- push in - red .....	73-76	1	<b>MT-45</b>	D3OZ-7A377A
	- push in - red - adjustable .....	73-76	1	<b>MT-34</b>	D3OZ-7A377A

## HARD PARTS - NEW

	<b>PUMP PARTS</b>				
15	Front Pump Gear Set .....	64-86	1	<b>8172-K</b>	C4AZ-7C010/011
NI	Anti-Balloon Sleeve Front Pump (bullet) .....	64-69	1	<b>8174-K</b>	
	<b>SPRAGS &amp; ROLLER CLUTCHES</b>				
F1	Spring & Roller Kit .....	64-86	1	<b>8550-K</b>	C4AZ-7D089A
	Spring & Roller Kit with Cage .....	78-on	1	<b>8403-K</b>	-
	Cage Assembly .....	78-on	1	<b>8816-K</b>	D8OZ-7D191A
	<b>SPRINGS</b>				
C3	Disc Spring, Forward Clutch Piston .....	64-86	1	<b>8624-K</b>	E1AZ-7B070A
	Spring & Retainer, Direct Clutch .....	64-69	1	<b>8173-K</b>	C4AZ-7A480C
	Spring & Retainer, Direct Clutch .....	70-86	1	<b>8118-K</b>	DOAZ-7A480B
	<b>SNAP RINGS</b>				
	Forward & Direct Clutch - .052" .....	64-86	sel	<b>12050-K</b>	DOAZ-7A577B
	- .066" .....	64-86	sel	<b>12051-K</b>	D0AZ-7A577A
	- .080" .....	64-86	sel	<b>12052-K</b>	D0AZ-7A577C
	- .094" .....	64-86	sel	<b>12053-K</b>	D0AZ-7A577D
	- .106" .....	64-86	sel	<b>12054-K</b>	E1AZ-7A577B
	- waved .....	81-86	sel	<b>12160-K</b>	E1AZ-7A577A
2	Forward Clutch Piston .....	64-86	1	<b>12055-K</b>	C4AZ-7D256A
	<b>MISCELLANEOUS</b>				
D9	Clutch Hub, Forward .....	65-80	1	<b>8809-K</b>	C5AZ-7B067B
NI	Valve & Spring Kit, Oil Filter .....	71-on	1	<b>9297-K</b>	D5AZ-7E368A
F2	Inner Sprag Race .....	64-86	1	<b>92100-K</b>	D4AZ-7D171A
NI	Filler Tube Repair .....	64-86	1	<b>96140</b>	

**FORD****C4, C5**

ILL	DESCRIPTION	YEARS	QTY	FATSCO	REFERENCE
<b>ELECTRICAL COMPONENTS</b>					
NI	Smog Switch .....	72-76	1	8582-K	D2AZ-7E440A
<b>REBUILT &amp; USED HARD PARTS</b>					
A6	Front Pump	64-E66	1	FC4-01	
A6	Front Pump	L66-69	1	FC4-01A	
A6	Front Pump	70-77	1	FC4-01B	
A6	Front Pump	78-81	1	FC4-01C	
A12	Input Shaft, 24 x 24 spline	64-69	1	FC4-25A	
A12	Input Shaft, 26 x 26 spline	1970	1	FC4-25B	
A12	Input Shaft, 26 x 24 spline	71-81	1	FC4-25C	
B10	Direct Drum - short	64-E65	1	FC4-05	
B10	Direct Drum, 3 pack	65-69	1	FC4-05A	
B10	Direct Drum, 4 pack	65-69	1	FC4-05B	
B10	Direct Drum, 3 pack	70-81	1	FC4-05C	
B10	Direct Drum, 4 pack	70-81	1	FC4-05D	
B10	Direct Drum, 2 pack	70-81	1	FC4-05E	
1	Direct Piston, Casting #	64-81	1	CALL	
C10	Forward Drum, 4 pack	64-69	1	FC4-06	
C10	Forward Drum, 5 pack	64-69	1	FC4-06A	
C10	Forward Drum,	1970	1	FC4-06B	
C10	Forward Drum, 4 pack	71-81	1	FC4-06C	
C10	Forward Drum, 5 pack	71-81	1	FC4-06D	
2	Forward Piston	64-81	1	CALL	
D9	Forward Clutch Hub, without bushing	64-65	1	FC4-16	
D9	Forward Clutch Hub, with bushing	66-81	1	FC4-16A	
	Front Planetary Ring Gear	64-81	1	FC4-13	
D8	Front Planetary (use with FC4-16)	64-65	1	FC4-10	
D8	Front Planetary, 1-piece bearing	65-81	1	FC4-10A	
D8	Front Planetary, 3-piece bearing	65-81	1	FC4-10B	
3	Sun Gear	64-81	1	FC4-20	
4	Sun Shell	64-E65	1	FC4-22	
4	Sun Shell	L65-81	1	FC4-22A	
E6	Rear Planetary	64-81	1	FC4-11	
5	Rear Ring Gear	64-81	1	FC4-14	
6	Rear Ring Gear Hub	64-81	1	FC4-17	
7	Reverse Drum	64-81	1	FC4-07	
8	Reverse Band Strut	64-81	1	CALL	
F2	Inner Sprag Race	64-81	1	FC4-46	
F17	Outer Sprag Race	64-81	1	FC4-46A	
	Transmission Case	1964	1	FC4-36	Small servo
	Transmission Case w/vent tube	65-69	1	FC4-36A	



	Transmission Case w/vent, slope case	65-69	1	<b>FC4-36B</b>	
	Transmission Case	70-72	1	<b>FC4-36C</b>	Screw in modulator
	Transmission Case, slope case	70-72	1	<b>FC4-36D</b>	Screw in modulator
	Transmission Case	72-81	1	<b>FC4-36E</b>	Push in modulator
	Transmission Case, slope case	72-81	1	<b>FC4-36F</b>	Push in modulator
9	Parking Gear, 11 lugs 5/8" thick	64-81	1	<b>FC4-47</b>	
9	Parking Gear, 15 lugs 5/8" thick	64-81	1	<b>FC4-47A</b>	
9	Parking Gear, 15 lugs 7/16" thick	64-81	1	<b>FC4-47B</b>	
10	Governor Distribution Sleeve, Cast C5AP	64-69	1	<b>FC4-34A</b>	
10	Governor Distribution Sleeve, Cast D0AP	70-81	1	<b>FC4-34B</b>	
G7	Governor Support	64-81	1	<b>FC4-34</b>	
11	Output Shaft	64-81	1	<b>CALL</b>	
20	Governor, Cast# C4AP	64-81	1	<b>FC4-32</b>	
20	Governor, Cast# D1AP	70-81	1	<b>FC4-32A</b>	
18	Manual Lever Shaft, column shift	64-81	1	<b>CALL</b>	
18	Manual Lever Shaft, floor shift	64-69	1	<b>FC4-67A</b>	
18	Manual Lever Shaft, floor shift	70-81	1	<b>FC4-67B</b>	
19	Throttle Lever Shaft	64-69	1	<b>FC4-74</b>	
19	Throttle Lever Shaft	70-81	1	<b>FC4-74A</b>	
12	Extension Housing	64-81	1	<b>CALL</b>	
16	Valve Body	1964	1	<b>FC4-33</b>	
16	Valve Body	65-66	1	<b>FC4-33A</b>	Green Dot
16	Valve Body	67-69	1	<b>FC4-33B</b>	8 bolt
16	Valve Body	70-81	1	<b>FC4-33C</b>	9 bolt
16	Valve Body	70-71	1	<b>FC4-33D</b>	Pinto, 8 bolt
16	Valve Body	72-81	1	<b>FC4-33E</b>	Pinto, 9 bolt
	Intermediate Servo Assembly	1964	1	<b>FC4-57</b>	Small Pin
	Intermediate servo assembly – Casting #	65-81	1	<b>FC4-57A</b>	
14	Transmission Oil Pan	64-81	1	<b>CALL</b>	

FORD

**C4, C5**

ILL	DESCRIPTION	YEARS	QTY	FATSCO	REFERENCE
-----	-------------	-------	-----	--------	-----------