

TEMPEST TORQUE (1961-1963)

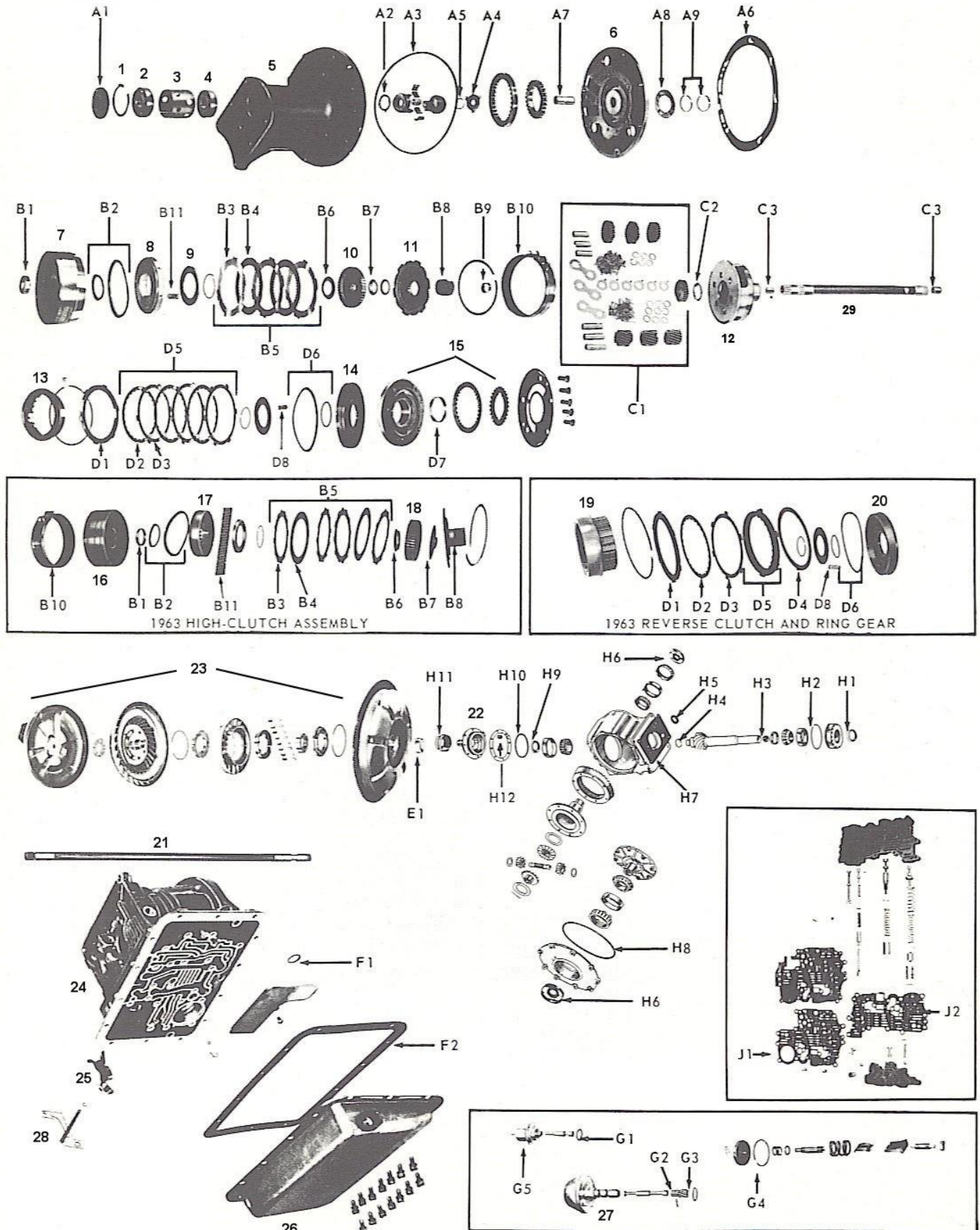

DESCRIPTION	YEAR	PART NUMBER	QTY	REF # / NOTES
KITS				
MASTER KIT W/CLUTCHES & STEELS	1961-1962	PS102C-1	1	
MASTER KIT W/CLUTCHES & STEELS	1963	PS102T8-1	1	
MAJOR KIT W/CLUTCHES	1961-1962	PS102C-2	1	
MAJOR KIT W/CLUTCHES	1963	PS12T8-2	1	
TRANSMISSION OVERHAUL KIT	1961-1962	PS102C-3	1	
TRANSMISSION OVERHAUL KIT	1963	PS102T8-3	1	
DIFFERENTIAL OVERHAUL SEAL KIT	1961-1962	PS102C-5B	1	
DIFFERENTIAL OVERHAUL SEAL KIT	1963	PS102T8-5	1	
GASKETS				
PAN GASKET	1961-1962	PG23-2A	1	14 BOLTS
PAN GASKET	1963	PG23-2B	1	16 BOLTS
FILTER				
FILTER SCREEN	1961-1963	PS150G	1	
O-RINGS				
PARK CABLE O-RING	1963	4676Z	1	NI
FILTER O-RING	1961-1963	4719E	1	F1
SEALS				
CONVERTER SEAL	1961-1962	PS2-9A	1	H11
CONVERTER SEAL	1963	543866	1	H11
AXLE SEALS	1961-1963	539392	1-2	H6
PINION SEAL	1961-1962	PS3-9	1-2	H1
PINION SEAL	1963	543620		H1
TURBINE SHAFT SEAL	1963	544264	1	NI
BAND				
LOW BAND	1961-1962	PS122	1	B10
LOW BAND	1963	PG122A	1	B10
MODULATOR				
VACUUM MODULATOR	1961-1962	MT-55	1	G5
VACUUM MODULATOR – 4 CYLINDERS	1963	MT-41	1	G5
VACUUM MODULATOR – 8 CYLINDERS	1963	MT-42	1	G5
FRICTIONS				
HIGH CLUTCH FRICTION	1961-1962	1282E	3	B3
REVERSE CLUTCH FRICTION	1961-1962	1324T	3	D2
HIGH CLUTCH FRICTION	1963	1282E	5	B3
REVERSE CLUTCH FRICTION	1963	1324T	5	D2

STEELS				
HIGH CLUTCH STEEL PLATE	1961-1962	PG4-1	4	B4
REVERSE CLUTCH STEEL PLATE	1961-1962	1197C	3	D3
HIGH CLUTCH STEEL PLATE	1963	1243C	5	B4
REVERSE CLUTCH STEEL PLATE	1963	1197C	5	D3
BUSHINGS				
BUSHING KIT	1961-1962	KPS106A	1	NI
BUSHING KIT	1963	KPS106B	1	NI
WASHERS				
THRUST WASHER KIT	1961-1962	KPS111A	1	NI
THRUST WASHER KIT	1963	KPS111T	1	NI
SEALING RINGS				
SEALING RING KIT	1961-1962	PS104A	1	NI
SEALING RING KIT	1963	PS104B	1	NI
NEW HARD PARTS				
GOVERNOR GEAR	1961-1962	3777168	1	G2
GOVERNOR GEAR	1963	3824032	1	G2
REBUILT / USED HARD PARTS				
FRONT PUMP	1961-1962	PT01	1	6
FRONT PUMP	1963	PT01A	1	6
HIGH CLUTCH DRUM	1961-1962	PT06	1	7
HIGH CLUTCH DRUM	1963	PT06A	1	16
PLANETARY	1961-1962	CS11	1	12
PLANETARY	1963	PT11	1	12
PLANET RING GEAR	1961-1962	CS14	1	13
PLANET RING GEAR	1963	PT14	1	19
REAR SUN GEAR	1961-1962	CS20	1	B8
REAR SUN GEAR	1963	PT20	1	B8
PUMP SHAFT	1961-1962	PT25	1	21
PUMP SHAFT	1963	PT25A	1	21
BELL HOUSING	1961-1962	PT30	1	NI
BELL HOUSING	1963	PT30A	1	NI
GOVERNOR	1961-1963	CS32	1	27
VALVE BODY	1961-1962	CS33	1	J2
VALVE BODY	1963	PT33	1	J2
HIGH CLUTCH PISTON – 3/4" TALL	1961-1962	CS39	1	8
HIGH CLUTCH PISTON – 5/8" TALL	1961-1962	CS39A	1	8

