

DYNAFLOW (1948-1963)

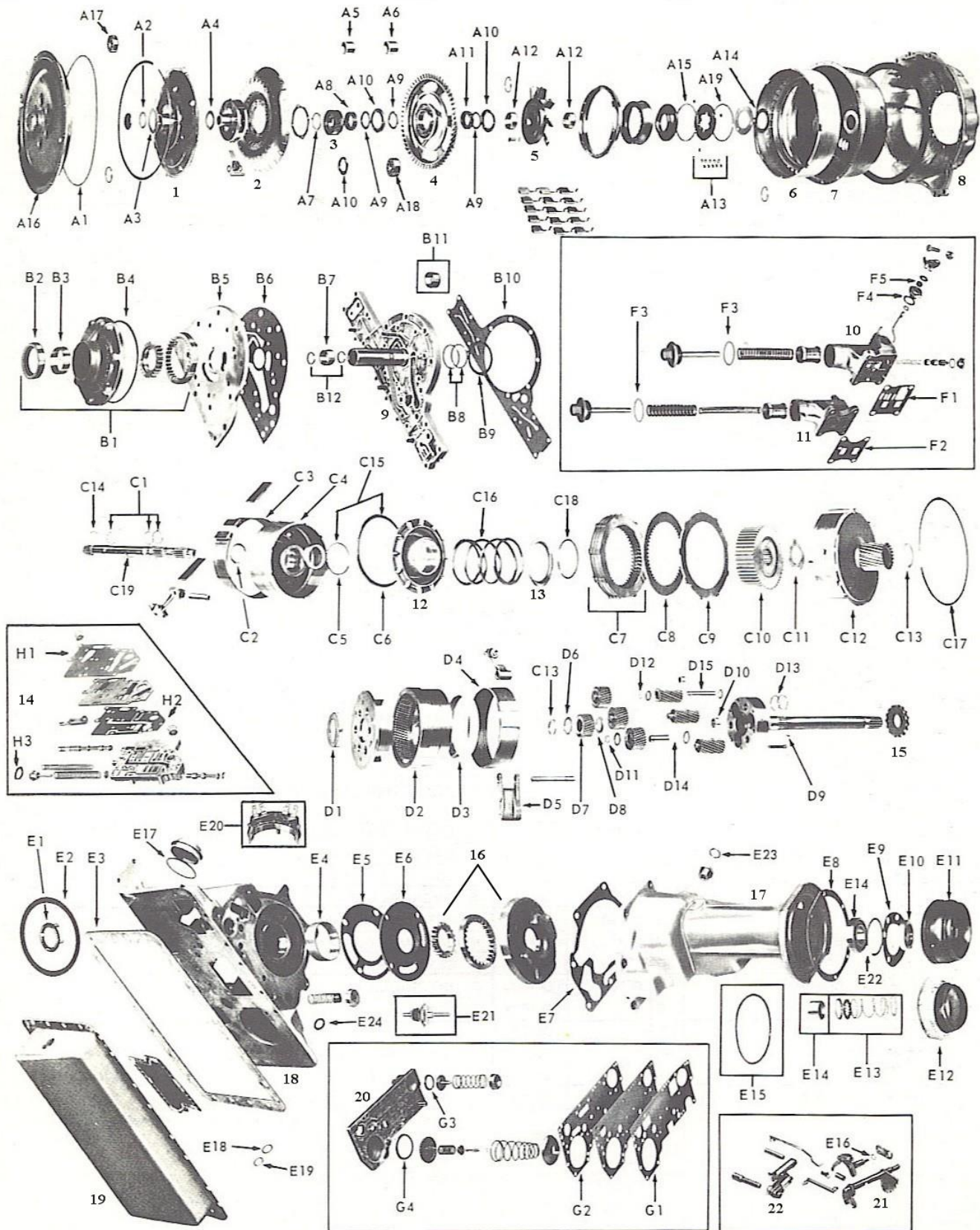

DESCRIPTION	YEAR	PART NUMBER	QTY	REF. NUMBER
KITS				
MASTER KIT	1948-1954	D102-1	1	
MASTER KIT	1955-1960	D102A-1	1	
MASTER KIT	1961-1963	D102B-1	1	
MAJOR KIT	1948-1954	D102-2	1	
MAJOR KIT	1955-1960	D102A-2	1	
MAJOR KIT	1961-1963	D102B-2	1	
OVERHAUL KIT	1948-1954	D102-3	1	
OVERHAUL KIT	1955-1960	D102A-3	1	
OVERHAUL KIT	1961-1963	D102B-3	1	
EXTERNAL SEAL KIT	1948-1954	D102-4	1	
EXTERNAL SEAL KIT	1955-1960	D102A-4	1	
EXTERNAL SEAL KIT	1961-1963	D102B-4	1	
GASKETS				
PAN GASKET	1948-1963	D6-2	1	E3
TORQUE BALL SHIM SET	1948-1960	D108	1	E8
FILTER				
OIL SCREEN FILTER	1948-1956	D117	1	
OIL SCREEN FILTER	1957-1963	D217	1	
O-RINGS				
CONVERTER COVER O-RING	1951-1952	PG5-12	1	A1
CONVERTER COVER LCS	1953-1963	D2-12	1	A1
SEALS				
FRONT PUMP SEAL	1948-1963	D2-9	1	B2
TORQUE BALL SEAL	1948-1952	D1-9	1	E10
TORQUE TUBE SEAL	1953-1958	D3-9	1	E10
TORQUE TUBE SEAL	1959-1960	D5-9	1	E10
EXTENSION HOUSING SEAL	1961-1963	D5-9A	1	NI
PROPELLER SHAFT SEAL KIT	1948-1953	KD109	1	E13
TORQUE BALL SEAL KIT	1948-1952	D110-9B	1	NI
TORQUE BALL SEAL KIT	1953-1960	D110-9C	1	NI

BANDS				
LOW BAND (FRONT)	1948-1958	D122	1	C3
REVERSE BAND (REAR)	1948-1958	D122A	1	D4
REVERSE BAND – ROADMASTER ONLY	1948-1949	D122E	1	D4
LOW BAND (FRONT)	1959-1963	D122B	1	C3
REVERSE BAND (REAR)	1959-1963	D122C	1	D4
BUSHINGS				
BUSHING KIT	1948-1954	KD106	1	NI
BUSHING KIT	1955-1963	KD106A	1	NI
PUMP BUSHING	1948-1963	D5-6A	1	B3
EXTENSION HOUSING BUSHING	1961-1963	5334BC	1	NI
WASHERS				
THRUST WASHER KIT	1948-1955	KD111	1	NI
THRUST WASHER KIT	1956-1963	KD111A	1	NI
SEALING RINGS				
SEALING RING KIT	1948-1954	D104C	1	NI
SEALING RING KIT	1955-1963	D104D	1	NI
NEW HARD PARTS				
TORQUE BALL BOOT	1948-1952	1334298	1	E11
TORQUE BALL BOOT	1953-1960	1170199	1	E11
TORQUE BALL RETAINER, BONDED RUBBER	1948-1960	D110-9A	1	E12
SPRING/ROLLER KIT	1948-1954	CALL	1	A13
SPRING/ROLLER KIT	1955-1963	1391959	1	A13
USED/REBUILT HARD PARTS				
TORUS BOWL (40 SERIES)	1948-1952	CNR-16A	1	7
TORUS BOWL (40 SERIES)	1948-1952	CNR-16B	1	7
TORUS BOWL (70 SERIES)	1948-1952	CNR-17	1	7
TORUS BOWL (70 SERIES)	1948-1952	CNR-17A	1	7
TORUS BOWL	1953-1954	CNR-18	1	7
TORUS BOWL, 5-9/16" TALL	1955	CNR-20	1	7
TORUS BOWL, 6-3/8" TALL	1956	CNR-19	1	7
TORUS BOWL	1956	CNR-19A	1	7
TORUS BOWL	1957-1958	CNR-14	1	7
TORUS BOWL	1959-1960	CNR-15	1	7
TORUS BOWL	1961-1963	CNR-13	1	7
FRONT PUMP ASSEMBLY	1948-1954	D01	1	B1
FRONT PUMP ASSEMBLY	1955-1958	D01A	1	B1
FRONT PUMP ASSEMBLY	1959-1963	D01B	1	B1

FRONT PUMP ASSEMBLY - ROADMASTER	1948-1949	D01C	1	B1
FRONT PUMP PLATE	1948-1954	D43	1	B5
FRONT PUMP LAMINATED PLATE	1948-1954	D43A	1	B5
FRONT PUMP PLATE	1955-1963	D43B	1	B5
REACTION FLANGE	1948-1952	D03	1	9
REACTION FLANGE	1953-1954	D03A	1	9
REACTION FLANGE	1955	D03B	1	9
REACTION FLANGE	1956	D03C	1	9
REACTION FLANGE	1957-1960	D03D	1	9
REACTION FLANGE	1961-1963	D03E	1	9
HIGH ACCUMULATOR	1948-1963	CALL	1	10
LOW ACCUMULATOR	1948-1963	CALL	1	11
HIGH CLUTCH DRUM	1948-1952	D06	1	C4
HIGH CLUTCH DRUM	1953-1954	D06A	1	C4
HIGH CLUTCH DRUM	1955-1956	D06B	1	C4
HIGH CLUTCH DRUM	1957-1958	D06C	1	C4
HIGH CLUTCH DRUM	1959-1963	D06D	1	C4
INPUT SHAFT	1948-1952	D25	1	C19
INPUT SHAFT	1953-1954	D25A	1	C19
INPUT SHAFT	1955	D25B	1	C19
INPUT SHAFT	1955	D25C	1	C19
INPUT SHAFT	1956	D25D	1	C19
INPUT SHAFT	1957-1963	D25E	1	C19
CLUTCH HUB	1948-1954	D59	1	C10
CLUTCH HUB	1955-1956	D59A	1	C10
CLUTCH HUB	1957-1963	D59B	1	C10
SUN GEAR FLANGE	1948-1954	D20	1	C12
SUN GEAR FLANGE	1955-1956	D20A	1	C12
SUN GEAR FLANGE	1957-1963	D20B	1	C12
REVERSE RING GEAR	1948-1952	D14	1	D2
REVERSE RING GEAR	1953-1963	D14A	1	D2
OUTPUT SHAFT, 4-3/4"	1948-1960	D11	1	D9
OUTPUT SHAFT, 9-1/2"	1948-1960	D11A	1	D9
OUTPUT SHAFT, 14-1/4"	1948-1960	D11B	1	D9
OUTPUT SHAFT, 8-1/2"	1961-1963	D11C	1	D9
OUTPUT SHAFT, 10-5/8"	1948-1960	D11D	1	D9
OUTPUT SHAFT, 9-1/2"	1956	D11E	1	D9
REVERSE BAND ANCHOR (ex Roadmaster)	1948-1960	1339423	1	D5
REVERSE BAND ANCHOR	1961-1963	1352975	1	D5
REVERSE BAND REPAIR LINK	1948-1963	1339424	1	NI
REAR PUMP ASSEMBLY	1948-1960	D60	1	16
REAR PUMP ASSEMBLY	1961-1963	D60A	1	16
REAR PUMP PLATE	1948-1963	D43D	1	E6
EXTENSION HOUSING	1948-1963	CALL	1	17
TRANSMISSION CASE	1948-1963	CALL	1	18

TRANSMISSION PAN	1948-1963	CALL	1	19
VALVE BODY	1948-1963	CALL	1	20
TORQUE BALL	1948-1960	CALL	1	NI
STARTER RING GEAR 3/8" THICK	1957-1963	165A	1	NI
STARTER RING GEAR 1/2" THICK	1957-1963	165B	1	NI