

# CAST IRON TORQUEFLITE (1956-1961)

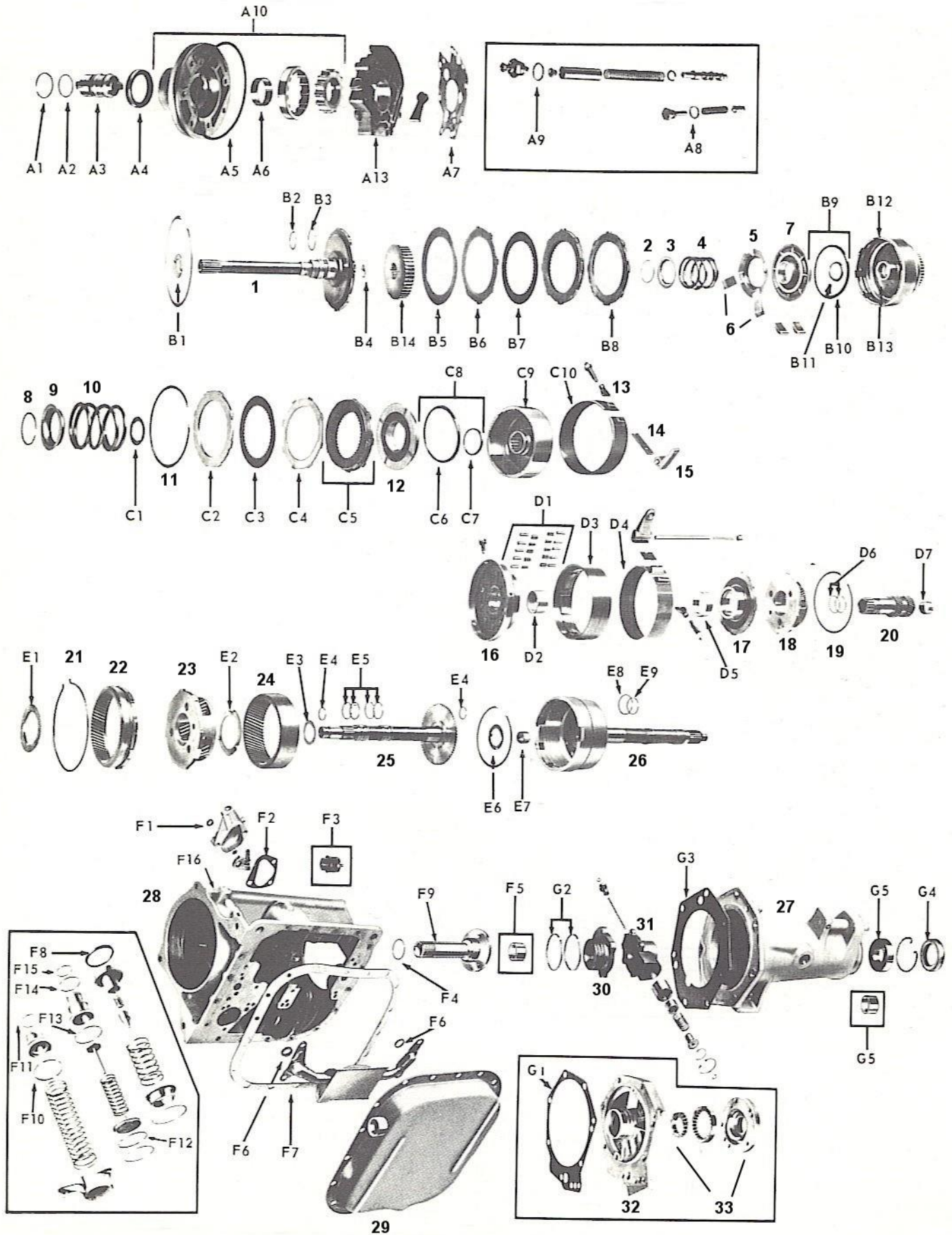

DESCRIPTION	YEAR	PART NUMBER	QTY	REF#/NOTES
<b>KITS</b>				
MASTER KIT W/CLUTCHES & STEELS	1956-1961	TF102-1	1	
MAJOR KIT W/CLUTCHES	1956-1961	TF102-2	1	
OVERHAUL KIT	1956-1961	TF102-3	1	
EXTERNAL SEAL KIT	1956-1961	TF102-4	1	
<b>GASKETS</b>				
PAN GASKET	1956-1961	C4-2	1	F7
EXTENSION HOUSING GASKET	1956-1958	C12-2	1	G3
EXTENSION HOUSING GASKET	1959-1961	C13-2	1	G3
SHIFT HOUSING GASKET	1956-1959	C7-2	1	F2
<b>FILTER</b>				
TRANSMISSION FILTER SCREEN	1956-1961	C2-17	1	
<b>O-RINGS</b>				
FRONT PUMP O-RING	1956-1961	C6-5	1	A5
FILTER TUBE O-RING	1956-1961	C8-5	2	F6
<b>SEALS</b>				
FRONT PUMP SEAL	1956-1961	C7-9	1	A4
EXTENSION HOUSING SEAL	1956-1958	C1-9	1	G4 (3167Q)
EXTENSION HOUSING SEAL	1959-1961	C8-9	1	G4
<b>BANDS</b>				
FRONT BAND	1956-1960	C122C	1	C10
FRONT BAND	1961	C122K	1	C10
REAR BAND	1956-1961	C122D	1	D4
<b>FRICCTIONS</b>				
FRONT & REAR FRICTION PLATE (.096")	1956-1961	C5-1	5	B7 / C3
FRONT & REAR FRICTION PLATE (.062")	1956-1961	C6-1	5	B7/ C3
FRONT & REAR FRICTION PLATE (.075")	1956-1961	C7-1	AR	B7 / C3
FRONT & REAR FRICTION PLATE (.087")	1956-1961	C8-1	AR	B7 / C3
<b>STEELS</b>				
FRONT & REAR STEEL PLATE (.070")	1956-1961	C4-1	8	B6 / C4
<b>BUSHINGS</b>				
BUSHING KIT	1956-1961	KC106A	1	NI
FRONT PUMP BUSHING	1956-1961	C12-6	1	A6
EXTENSION HOUSING BUSHING	1959-1964	C7-6A	1	G5

<b>WASHERS</b>				
THRUST WASHER KIT	1956-1961	KC111A	1	NI
<b>SEALING RINGS</b>				
SEALING RING KIT	1956-1961	TF104	1	NI
<b>NEW HARD PARTS</b>				
FRONT CLUTCH DRUM SLEEVE	1956-1961	TF06B	1	B13
EXTENSION HOUSING BEARING	1956-1958	206-1	1	G5 (NLA)
SPRING & ROLLER SET	1956-1961	TF50	1	D1
NEUTRAL SAFETY SWITCH	1956-1961	8001Q	1	F3
<b>REBUILT/USED HARD PARTS</b>				
FRONT PUMP DRIVE SLEEVE	1956-1961	TF103	1	A3
FRONT PUMP ASSEMBLY	1956-1961	TF01	1	A10
PRESSURE REGULATOR BODY	1956-1961	TF104	1	A13
INPUT SHAFT	1956-1961	TF25	1	1
FRONT CLUTCH HUB - .822" tall	1956-1958	TF59A	1	B14
FRONT CLUTCH HUB -.676" tall	1959-1961	TF59	1	B14
BEVEL SPRING	1956-1961	TF45B	1	B5
CUSHION SPRING	1956-1961	TF45G	1	B6
FRONT CLUTCH APPLY PLATE	1956-1961	TF44	1	B8
FRONT CLUTCH PISTON # 1736407	1956-1961	TF39	1	7
FRONT CLUTCH PISTON # 1853858	1956-1961	TF39A	1	7
FRONT CLUTCH PISTON #1636274	1956-1961	TF39B	1	7
FRONT CLUTCH DRUM – SKINNY LEVERS	1956	TF06	1	B12
FRONT CLUTCH DRUM – 4 LEVERS	1957-1958	TF06A	1	B12
FRONT CLUTCH DRUM – 8 LEVERS	1959-1961	TF06B	1	B12
REAR CLUTCH PRESSURE PLATE	1956-1961	TF44	1	C2
REAR CLUTCH PISTON #1736333	1956-1961	TF40	1	12
REAR CLUTCH PISTON #1636276	1956-1961	TF40A	1	12
REAR CLUTCH DRUM	1956-1961	TF05	1	C9
CENTER SUPPORT	1956-1961	TF28	1	16
INNER SPRAG RACE	1956-1961	TF46	1	17
FRONT PLANETARY	1956-1961	TF11	1	18
SUN GEAR	1956-1961	TF20	1	20
FRONT PLANET RING GEAR	1956-1961	TF13	1	22
REAR PLANETARY	1956-1961	TF11	1	23
REAR PLANETARY	1956-1961	TF11A	1	23
REAR PLANETARY	1956-1961	TF11B	1	23
REAR PLANET RING GEAR	1956-1961	TF14	1	24
INTERMEDIATE SHAFT	1956-1961	TF79	1	25
OUTPUT SHAFT, 1 SEALING RING	1956-1958	TF52	1	26
OUTPUT SHAFT, 2 SEALING RING	1959-1961	TF52A	1	26

OUTPUT SHAFT	1959-1961	TF52B	1	26
TRANSMISSION CASE – CAST #	1956-1961	CALL	1	28
STATOR SHAFT – ALUMINUM	1956-1961	TF03	1	F9
STATOR SHAFT – CAST IRON	1956-1961	TF03A	1	F9
GOVERNOR SUPPORT – CAST #	1956-1961	CALL	1	30
GOVERNOR #3850588	1956-1961	TF32	1	31
GOVERNOR #1736311	1956-1961	TF32A	1	31
EXTENSION HOUSING – CAST #	1956-1961	CALL	1	27
TRANSMISSION PAN	1956-1961	TF48	1	29
OUTPUT SUPPORT #1636312	1956-1957	TF106	1	32
OUTPUT SUPPORT #1824457 / 1823808	1958-1961	TF106A	1	32
REAR PUMP ASSEMBLY	1956-1961	TF60	1	33
VALVE BODY	1956-1961	CALL	1	NI
PARKING BRAKE SHOES	1956-1961	PF113	1	NI
ALUMINUM SHIFT HOUSING #1672073	1956-1959	TF110	1	
SPEEDOMETER HOUSING/GEAR	1956-1961	TF130	1	count teeth