

# DUAL PATH (1961 - 1963)

23

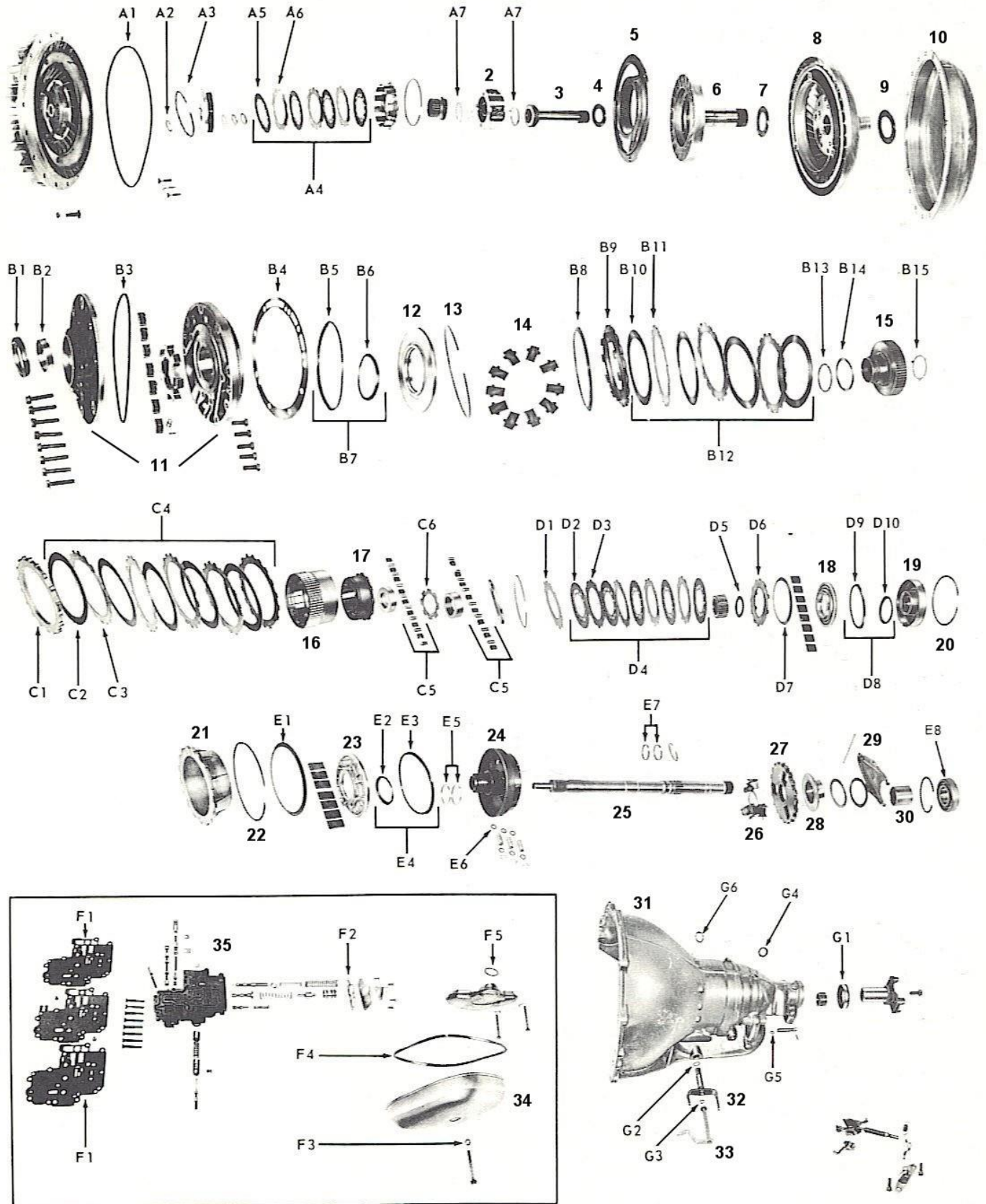

DESCRIPTION	YEAR	PART NUMBER	QTY	REF# / NOTES
<b>KITS</b>				
MASTER KIT W/CLUTCHES & STEELS	1961-1963	DS102-1	1	NI
MAJOR KIT W/CLUTCHES	1961-1963	DS102-2	1	NI
OVERHAUL KIT	1961-1963	DS102-3	1	NI
<b>GASKETS</b>				
PAN GASKET, MOLDED RUBBER	1961-1963	DS4-12	1	F4
<b>SEALS</b>				
FRONT PUMP SEAL	1961-1963	DS1-9	1	B1
REAR SEAL	1961-1963	3146D	1	G1
<b>FRICTIONS</b>				
CONVERTER FRICTION PLATE	1961-1963	DS7-1	4	A5
REVERSE FRICTION PLATE	1961-1963	DS3-1	4	B10
COAST FRICTION PLATE	1961-1963	DS7-1	5	D2
FORWARD FRICTION PLATE	1961-1963	DS3-1	5	C2
<b>STEELS</b>				
CONVERTER STEEL PLATE	1961-1963	DS8-1	3	A6
REVERSE STEEL PLATE	1961-1963	DS4-1	3	B11
COAST STEEL PLATE	1961-1963	DS8-1	4	D3
FORWARD STEEL PLATE	1961-1963	DS10-1	5	C3
<b>BUSHINGS</b>				
PUMP BUSHING	1961-1963	DS1-6	1	B2
<b>WASHERS</b>				
THRUST WASHER KIT	1961-1963	KDS111	1	NI
<b>SEALING RINGS</b>				
SEALING RING KIT	1961-1963	DS104	1	NI
<b>NEW HARD PARTS</b>				
SPRING & ROLLER KIT (.618")	1961-1962	1388996	1-2	C5
SPRING & ROLLER KIT (.605") W/BRASS KEYS	1963	1396108	1-2	C5
SPRING & ROLLER KIT (.605") W/O BRASS KEYS	1963	1396280	1-2	C5
<b>REBUILT/USED HARD PARTS</b>				
FRONT CONVERTER COVER	1961-1963	DP109	1	
FRONT CONVERTER COVER	1963	DP109A	1	
FRONT SUN GEAR	1961	DP109C	1	
FRONT SUN GEAR	1961-1963	DP109D	1	

PLANETARY CARRIER	1961	DP109H	1	2
PLANETARY CARRIER	1961-1963	DP109I	1	2
REAR SUN GEAR, 41TH	1961	DP109F	1	3
REAR SUN GEAR, 42TH	1961-1963	DP109G	1	3
PLANET RING GEAR	1961	DP109J	1	5
PLANET RING GEAR	1961-1963	DP109K	1	5
CONVERTER STATOR	1961-1963	DP105A	1	6
TURBINE SHAFT	1961-1963	DP105	1	8
PRIMARY PUMP	1961-1963	CNR-16	1	10
FRONT PUMP	1961-1963	DP02	1	11
REVERSE CLUTCH HOUSING	1961-1963	DP03	1	12
APPLY LEVER	1961-1963	1348649	10	14
REVERSE CLUTCH HUB	1961-1963	DP59A	1	15
COAST CLUTCH HOUSING	1961-1963	DP09	1	16
FREEWHEEL CAM	1961-1962	DP35A	1	17
FREEWHEEL CAM	1963	DP35	1	17
COAST CLUTCH PISTON	1961-1963	DP76	1	18
COAST CLUTCH DRUM	1961-1962	DP09A	1	19
COAST CLUTCH DRUM	1963	DP09B	1	19
COAST CLUTCH OIL FEED TUBE	1961-1963	1173471	3	NI
FORWARD CLUTCH PRESSURE PLATE	1961-1963	DP44C	1	21
FORWARD CLUTCH PISTON	1961-1963	DP39	1	23
FORWARD CLUTCH DRUM	1961-1962	DP28	1	24
FORWARD CLUTCH DRUM	1962-1963	DP28A	1	24
OUTPUT SHAFT, 2 RING	1961-1963	DP52	1	25
OUTPUT SHAFT, 3 RING	1963	DP52A	1	25
OUTPUT SHAFT, 3 RING STEPPED PILOT END	1963	DP52B	1	25
GOVERNOR	1961-1963	1195909	1	26
GOVERNOR	1962-1963	1353362	1	26
PARKING WHEEL	1961-1963	DP47	1	27
GOVERNOR LEVER	1961-1963	1194386	1	29
TRANSMISSION CASE	1961-1963	DP36	1	31
MANUAL LEVER	1961-1963	1195127	1	32
THROTTLE LEVER	1961-1963	1164393	1	33
TRANSMISSION PAN	1961-1963	DP48	1	34
VALVE BODY	1961-1963	DP33	1	35