

TURBOGLIDE (1957-1961)

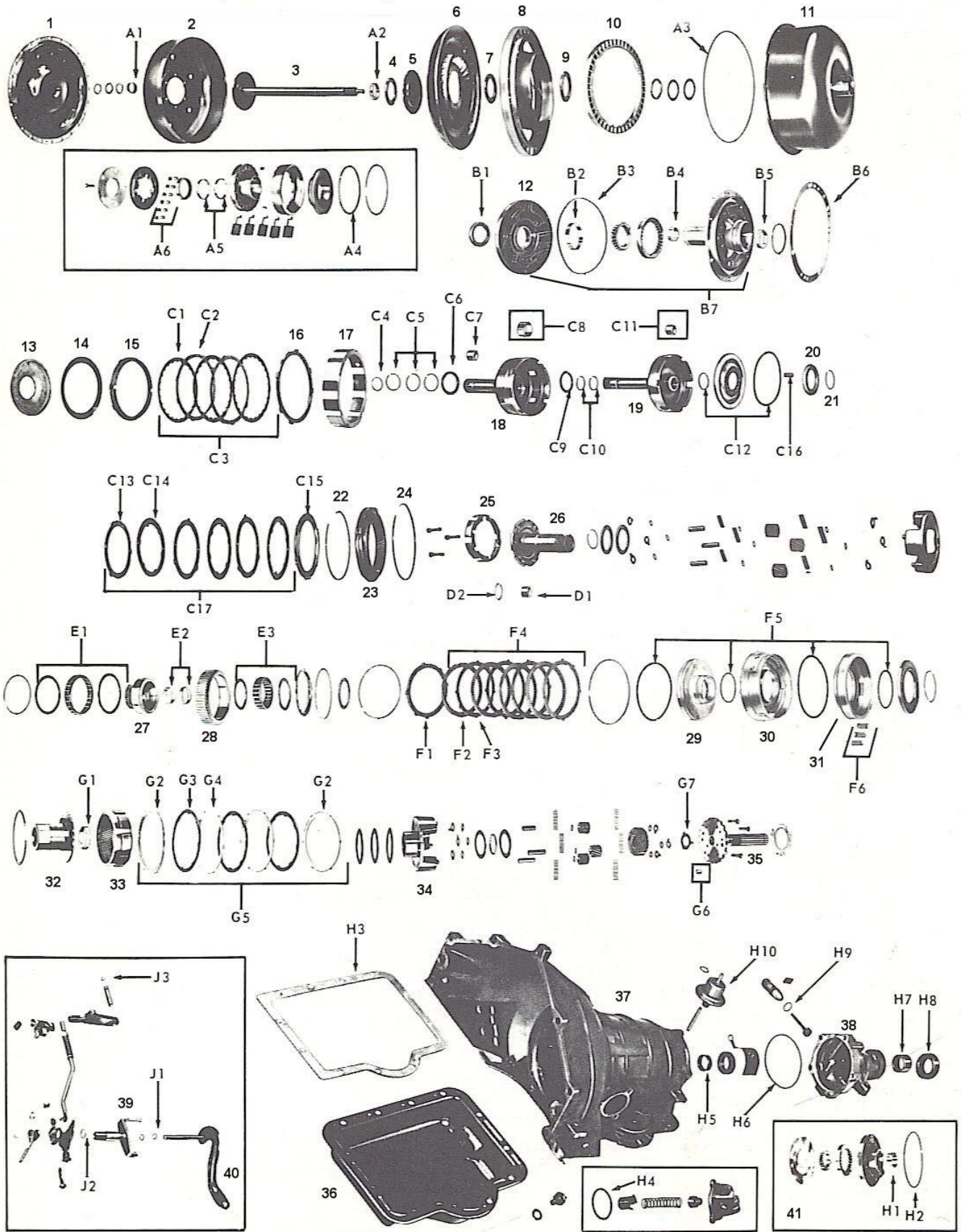

DESCRIPTION	YEAR	PART NUMBER	QTY	REF#/NOTES
KITS				
MASTER KIT W/CLUTCHES & STEELS	1957	TG102-1	1	NI
MASTER KIT W/CLUTCHES & STEELS	1958	TG102A-1	1	NI
MASTER KIT W/CLUTCHES & STEELS	1959-1961	TG102B-1	1	NI
MAJOR KIT W/CLUTCHES	1957	TG102-2	1	NI
MAJOR KIT W/CLUTCHES	1958	TG102A-2	1	NI
MAJOR KIT W/CLUTCHES	1959-1961	TG102B-2	1	NI
OVERHAUL KIT	1957	TG102-3	1	NI
OVERHAUL KIT	1958	TG102A-3	1	NI
OVERHAUL KIT	1959-1961	TG102B-3	1	NI
GASKETS				
PAN GASKET	1957-1961	PG23-2	1	H3
FILTER				
O-RINGS				
CONVERTER O-RING	1957-1960	PG8-12	1	A3
CONVERTER O-RING	1961	PG8-12A	1	A3
THROTTLE SHAFT O-RING	1957-1961	D11-5	1	J1
MANUAL LEVER O-RING	1957-1961	4523F	1	J2
SPEEDOMETER HOUSING O-RING	1957-1961	4676Z	1	H9
SEALS				
FRONT PUMP SEAL	1957-1961	PG4-9	1	B1
EXTENSION HOUSING SEAL	1957-1961	H3-9	1	H8 (3146D)
FRICTIONS				
NEUTRAL CLUTCH FRICTION	1958-1961	PG9-1	3	C14
FORWARD CLUTCH FRICTION	1959-1961	PG12-1	4	F2
BRAKE CLUTCH FRICTION	1957-1961	PG14-1	4	G3
REVERSE CLUTCH FRICTION	1959-1961	1324T	3	C1
STEELS				
NEUTRAL CLUTCH STEEL	1958-1961	PG7-1	3	C13
FORWARD CLUTCH STEEL	1959-1961	PG10-1	4	F3
REVERSE REACTION STEEL	1959-1961	PG11-1	2	C2
INNER REACTOR STEEL	1958-1961	PG16-1	2	G4
OUTER REACTOR STEEL	1957-1961	PG17-1	2	G2

BUSHINGS				
BUSHING KIT	1957-1961	KTG106	1	NI
PUMP BUSHING	1957-1961	PG23-6	1	B2
EXTENSION HOUSING BUSHING	1957-1961	PG15-6	1	H7 (5334BC)
WASHERS				
THRUST WASHER KIT	1957-1961	CALL		
SEALING RINGS				
SEALING RING KIT	1957-1961	TG104	1	NI
MODULATOR				
MODULATOR (FEMALE THREAD)	1957	MT-87	1	H10
MODULATOR (MALE THREAD)	1958-1961	MT-88	1	H10
REBUILT/USED HARD PARTS				
CONVERTER BOWL	1957-1961	CNR-11	1	11
FRONT PUMP	1957	TG01	1	B7
FRONT PUMP	1958	TG01A	1	B7
FRONT PUMP	1959-1961	TG01B	1	B7
FRONT RING GEAR HUB – 2 BUSHING	1957-1958	TG59	1	18
FRONT RING GEAR HUB – 1 BUSHING	1957-1958	TG59A	1	18
FRONT RING GEAR HUB – 25 SLOTS	1959-1961	TG59B	1	18
NEUTRAL CLUTCH DRUM	1957	TG05	1	19
NEUTRAL CLUTCH DRUM	1958	TG05A	1	19
NEUTRAL CLUTCH DRUM	1959-1961	TG05B	1	19
FRONT SUN GEAR	1957-1961	TG19	1	27
SPRAG RACE	1957-1958	TG46	1	28
SPRAG RACE	1959-1961	TG46A	1	28
REAR RING GEAR HUB	1957	CALL	1	32
REAR RING GEAR HUB	1958	CALL	1	32
REAR RING GEAR HUB	1959-1961	CALL	1	32
REAR RING GEAR	1957	TG14	1	33
REAR RING GEAR	1958	TG14A	1	33
REAR RING GEAR	1959-1961	TG14B	1	33
OUTPUT SHAFT / REAR PLANETARY	1957	TG11	1	35
OUTPUT SHAFT / REAR PLANETARY	1958-1961	TG11A	1	35
TRANSMISSION PAN	1957-1961	TG48	1	36
TRANSMISSION CASE	1957-1961	CALL	1	37
EXTENSION HOUSING	1957-1961	CALL	1	38
REAR PUMP	1957-1961	TG60	1	41