

SUPER TURBINE 300 (1964 - 1969)

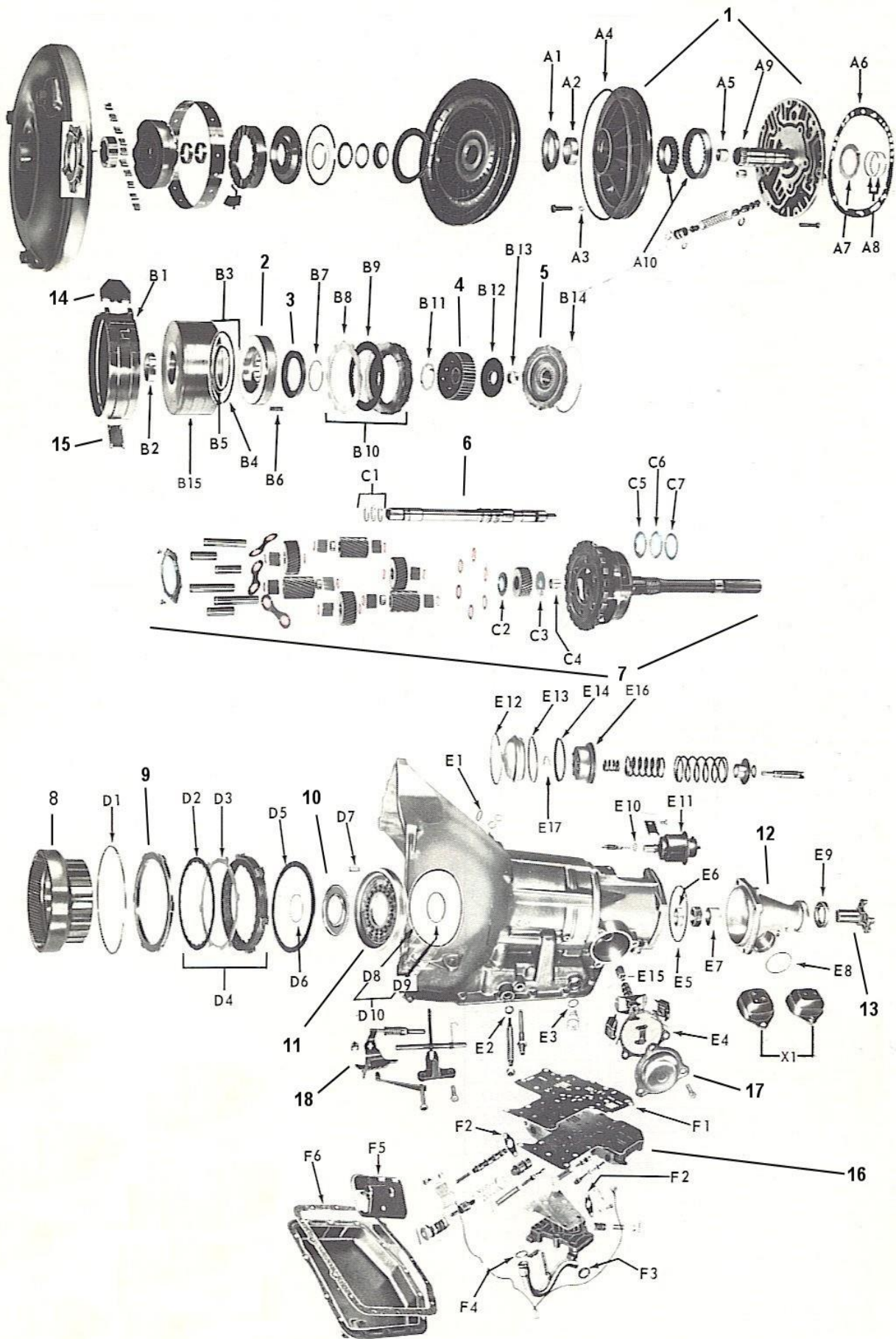

GENERAL MOTORS

ST 300

ILL	DESCRIPTION	YEARS	QTY	FATSCO	REFERENCE
-----	-------------	-------	-----	--------	-----------

REBUILDING KITS

DESCRIPTION	YEARS	MASTER KIT	MAJOR KIT	OVERHAUL KIT	PAPER/RUBBER
ST 300	64-69	152-EX	252-EX	300-EX	517-EX

CLUTCH PLATES

FRICITION PLATES					
B9	High - .098"	64-69	5-6	1282-E	1373575
D2	Reverse - .098"	64-69	5-6	1324-T	1375558
STEEL PLATES					
B8	High - .070"	64-69	5-6	1195-C	1361925
D3	Reverse - .070"	64-69	5-6	1197-C	1379373
	- .102"	64-69	ar	1198-C	
	- .134"	64-69	ar	1199-C	

GASKETS

F6	Oil Pan - fiber	64-69	1	2449-E	1376720
F6	- cork & rubber	64-69	1	2448-E	1376720
A6	Front Pump	64-69	1	2450-E	1374598
E4	Governor Cover	64-69	1	2452-E	1359113
NI	Valve Body Plate	64-69	1	2451-E	1378520
NI	Kickdown Solenoid	64-69	1	2443-E	1358640
NI	Stator Solenoid	64-65	1	2443-E	1358640
	66-69	1	2605-E	1372646

O'RINGS & RUBBER SEALS

A4	LCS, Front Pump to Case	64-69	1	4714-E	6261413
NI	Lip Seal, Low Servo Piston	64-69	1	4132-E	1356964
A3	O'ring, Front Pump to Case Bolt	64-65	8	4626-C	3789024
A3	Washer Seal, Front Pump to Case Bolt	66-69	8	9270-C	3884683
NI	LCS, Low Servo Cover	64-69	1	4724-E	1191493
NI	O'ring, Oil Filler Tube	64-69	1	4702-BC	6255641
E10	O'ring, Vacuum Modulator	64-69	1	4676-Z	8619568
E3	O'ring, Solenoid Connector	64-69	1	4676-Z	8619568
E5	LCS, Extension Housing	64-69	1	4723-E	1358899
E8	O'ring, Speedometer Sleeve	64-69	1	4716-E	1359319
NI	Seal, Speedometer Shaft - w/o spring	64-69	1	4822-E	1196792
	- with spring	64-69	1	4819-BC	optional
NI	O'ring, Oil Suction Pipe to Case	64-69	1	4719-E	1363951
CLUTCH PISTON SEALS					
B5	Lip Seal, Forward Clutch - inner	64-69	1	4130-E	1356811
B4	Lip Seal, Forward Clutch - outer	64-69	1	4131-E	1362832
3	Cushion, Forward Clutch	64-69	1	1386300	1386300
D9	LCS, Reverse Clutch - inner	64-69	1	4541-V	3812830
D8	LCS, Reverse Clutch - outer	64-69	1	4658-C	3812831

D5	Cushion, Reverse Clutch	64-69	1	1371859	1371859
	MOLDED PISTONS				
NI	Piston, Low Servo	68-69	1	1384396	1384396
METAL CLAD SEALS					
A1	Front Pump	64-69	1	3178-E	8641826
E9	Extension Housing - with flange	64-69	1	3146-D	1243402
E9	- w/o flange	64-69	1	3147-G	3932255
E9	- rubber coated	64-69	1	3115-G	3932255 / optional
E2	Manual Lever Shaft	64-69	1	3179-L	8623056
BUSHINGS					
NI	Bushing Kit	64-69	1	5046-EX	
A2	Front Pump Body - babbit	64-69	1	5295-L	8623940
A5	Stator Shaft	64-69	1	5346-BC	1381366
B2	Clutch Drum	64-69	1	5282-C	3840760
B13	Low Sun Gear	64-69	1	5346-BC	1381366
C4	Input Shaft Pilot	64-69	1	5146-G	3789034
NI	Case to Output Shaft	64-69	1	5300-E	1367730
E7	Extension Housing - babbit	64-69	1	5148-G	3717628
	- bronze	64-69	1	5334-BC	6260048 / optional
NI	Governor Bore Repair	64-69	1	8163-L	
WASHERS, BEARINGS, RACES & SHIMS					
	KITS				
NI	Washer Kit - selective	64-69	1	6071-EX	
	WASHERS & SHIMS				
A7	Front Pump - .061"	64-69	ar	6538-E	1356904
A7	- .079"	64-69	ar	6539-E	1356905
A7	- .097"	64-69	ar	6540-E	1356906
B11	High Clutch Hub to Drum – 2 tabs	64-66	1	1362027	1362027
B11	High Clutch Hub to Drum – 6 internal notches	67-69	1	6541E	1377665
B12	High Clutch Hub to Sun Gear Flange	64-69	1	PG12-11B	3783286
C3	Planetary to Internal Sun Gear – no tabs.....	64-65	1	1359022	1965 Pontiac
C3	Planetary to Internal Sun Gear – 3 tabs.....	65-69	1	1373336	1965 Buick/Olds
C2	Sun Gear Flange to Sun Gear Bearing.....	64-69	1	3818528	3818528
C5	Planetary to Case Bearing Race – front	64-69	1	1366679	1366679
C6	Planetary to Case Bearing	64-69	1	1194558	1194558
C7	Planetary to Case Bearing Race – rear	64-69	1	1366680	1366680
SEALING RINGS					
NI	Sealing Ring Kit	64-69	1	7059-EX	
A8	Clutch Drum	64-69	2	7209-G	3689808
C1	Input Shaft	64-69	3	7271-B	1367471
NI	Low Servo Piston	64-69	1	7796-E	1372058
FILTERS					
F5	Filter - 1st design	1964	1	943-E	1365288
NI	- 2nd design	L64-69	1	ST-16	1374649
NI	Filter Kit - 1st design	1964	1	450-EX	
	- 2nd design	L64-69	1	750-EX	

GENERAL MOTORS

ST 300

ILL	DESCRIPTION	YEARS	QTY	FATSCO	REFERENCE
BANDS					
B1	Low Brake Band	64-69	1	BT-17	3883918
MODULATORS					
E11	Modulator - red stripe - adjustable	64-69	1	MT-23	
	- medium can - brass	64-69	1	MT-56	
HARD PARTS - NEW					
PUMP PARTS					
A10	Front Pump Gear Set	64-69	1	8168-E	
NI	Cooler Bypass Valve	64-69	1	3857482	
SNAP RINGS					
NI	Snap Ring Kit	64-69	1	7780-EX	1396973
NI	Clutch Flange	64-69	1	7920-C	3779908
	64-69	1	7921-C	3779911
NI	Reverse Clutch Piston Spring Retainer	64-69	1	7919-V	6255698
NI	Low Servo Cover	64-69	1	7950-E	1357393
NI	Low Servo Piston	64-69	1	7957-L	8623508
MISCELLANEOUS					
NI	Speedometer Gear Clip	64-69	1	9298-E	6261353
E15	Governor Gear	64-69	1	8166-E	1396570
NI	Governor Assembly	64-69	1	8164-E	6261706
ELECTRICAL COMPONENTS					
NI	Case Connector - 2 contact	64-67	1	8167-E	2984091
	- 1 contact	64-69	1	9295-L	8626252
NI	Stator Control Solenoid - on pump	64-67	1	8162-L	1993390
	- on valve body	64-65	1	8169-E	1993623
NI	Kickdown Solenoid - w/cruise control	64-69	1	8169-E	1993330
	- w/o cruise control	64-69	1	8169-E	1993374
HART PARTS - REBUILT / USED					
1	Front Pump, V.P. w/holes for solenoid	64-67	1	300-01	
1	Front Pump, Non-Variable Pitch	64-69	1	300-01A	
1	Front Pump w/o holes for solenoid	64-65	1	300-01B	
B15	High Clutch Drum	64-69	1	300-06	
2	High Clutch Piston	64-69	1	CALL	
4	High Clutch Hub (use w/brass washer)	64-69	1	300-59	
4	High Clutch Hub (use w/fiber washer)	64-69	1	300-59A	
5	Sun Gear Flange	64-69	1	300-20	
6	Input Shaft - 3 ring Variable Pitch	64-67	1	300-25	
6	Input Shaft - 2 ring Non-Variable Pitch	64-69	1	300-25A	
7	Planetary Assembly	64-69	1	CALL	
8	Ring Gear Hub	64-69	1	300-14	

9	Reverse Pressure Plate .320"	64-69	1	300-44	1 ID Groove
9	Reverse Pressure Plate .353"	64-69	1	300-44A	2 ID Grooves
9	Reverse Pressure Plate .387"	64-69	1	300-44B	3 ID Grooves
10	Reverse Clutch Spring Retainer Plate	64-69	1	1362452	1362452
11	Reverse Clutch Piston	64-69	1	CALL	
12	Extension Housing, 6" long	64-69	1	300-37	
12	Extension Housing, 12-5/8" long	64-69	1	300-37A	
	Transmission Pan (use with 943E filter)	1964	1	300-48	
	Transmission Pan (use with ST16 filter)	L64-69	1	300-48A	
16	Valve Body	64-69	1	CALL	Casting #
	Transmission Case	64-69	1	CALL	
E16	Low Servo Piston	64-65	1	300-57	
E16	Low Servo Piston	66-67	1	300-57A	
E16	Low Servo Piston	68-69	1	300-57B	
	Torque Converter – Variable Pitch	64-67	1	B1	R&R ONLY
	Torque Converter – Non-Variable Pitch	68-69	1	B1A	

GENERAL MOTORS

ST 300

ILL	DESCRIPTION	YEARS	QTY	FATSCO	REFERENCE
-----	-------------	-------	-----	--------	-----------