

HYDRAMATIC (1946-1962)

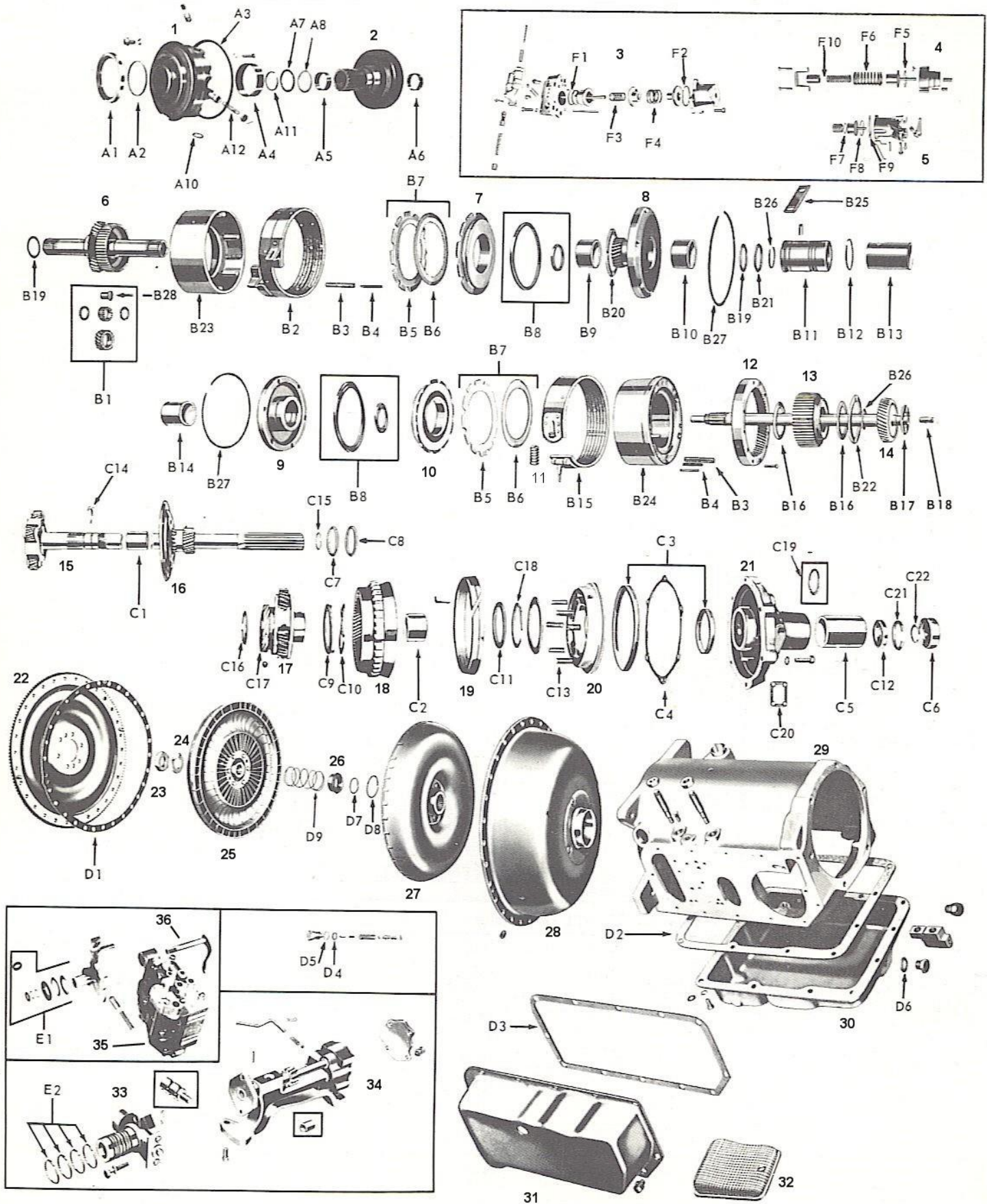

DESCRIPTION	YEAR	PART NUMBER	QTY	REFERENCE #
KITS				
MASTER KIT - CADILLAC	1941-1942	H102B-1	1	
MASTER KIT – All Except Below	1946-1956	H102A-1	1	
MASTER KIT - CADILLAC	1946-1948	H102-1	1	
MASTER KIT - PONTIAC	1952-1954	H102A-1P	1	
MASTER KIT – ROLLS ROYCE / BENTLEY	1952-1966	H102R-1	1	
MASTER KIT 1946-1950 PONTIAC 1950 HUDSON 1949-1950 NASH 1946-1950 OLDSMOBILE	1946-1950	H102A-1X	1	
MASTER KIT - OLDSMOBILE	1951	H102A-1Y	1	
MASTER KIT – GMC/CHEVY PICK UP	1953-On	H102A-1W	1	
MASTER KIT- OLDSMOBILE	1955-1956	H102A-1Z	1	
MAJOR KIT – CADILLAC	1941-1942	H102B-2	1	
MAJOR KIT – All Except Below	1946-1956	H102A-2	1	
MAJOR KIT – CADILLAC	1946-1948	H102-2	1	
MAJOR KIT – PONTIAC	1952-1954	H102A-2P	1	
MAJOR KIT – ROLLS ROYCE / BENTLEY	1952-1966	H102R-2	1	
MAJOR KIT 1946-1950 PONTIAC 1950 HUDSON 1949-1950 NASH 1946-1950 OLDSMOBILE	1946-1950	H102A-2X	1	
MAJOR KIT - OLDSMOBILE	1951	H102A-2Y	1	
MAJOR KIT – GMC/CHEVY PICK UP	1953-On	H102A-2W	1	
MAJOR KIT – OLDSMOBILE	1955-1956	H102A-2Z	1	
OVERHAUL KIT – CADILLAC	1941-1942	H102B-3	1	
OVERHAUL KIT – All Except Below	1946-1956	H102A-3	1	
OVERHAUL KIT – CADILLAC	1946-1948	H102-3	1	
OVERHAUL KIT – PONTIAC	1952-1954	H102A-3P	1	
OVERHAUL KIT – ROLLS ROYCE	1952-1966	H102R-3	1	
OVERHAUL KIT 1946-1950 PONTIAC 1950 HUDSON 1949-1950 NASH 1946-1950 OLDSMOBILE	1946-1950	H102A-3X	1	
OVERHAUL KIT – OLDSMOBILE	1951	H102A-3Y	1	
OVERHAUL KIT - GMC/CHEVY PICK UP	1953-On	H102A-3W	1	
OVERHAUL KIT - OLDSMOBILE	1955-1956	H102A-3Z	1	

EXTERNAL SEAL KIT	1946-1950	H102-4	1	
EXTERNAL SEAL KIT – All Except Below	1951-1956	H102A-4	1	
EXTERNAL SEAL KIT – GMC/CHEVY PICK UP	1953-On	H102A-4W	1	
EXTERNAL SEAL KIT 1946-1950 PONTIAC 1950 HUDSON 1949-1950 NASH 1946-1950 OLDSMOBILE	1946-1950	H102A-4X	1	
EXTERNAL SEAL KIT - OLDSMOBILE	1951	H102A-4Y	1	
EXTERNAL SEAL KIT - OLDSMOBILE	1955-1956	H102A-4Z	1	
EXTERNAL SEAL KIT – ROLLS ROYCE	1952-1966	H102R-4	1	
GASKETS				
PAN GASKET - OLDSMOBILE	1940	H15-2B	1	D2
PAN GASKET - CADILLAC	1941-1942	H15-2A	1	D2
PAN GASKET – All Except Below	1946-1966	H15-2	1	D2
PAN GASKET – ROLLS ROYCE/BENTLEY	1952-1966	UG809	1	D2
SIDE COVER GASKET - CADILLAC	1941-1942	H9-2A	1	D3
SIDE COVER GASKET	1946-1950	H9-2	1	D3
SIDE COVER GASKET	1951	H6-2	1	D3
SIDE COVER GASKET – All Except Below	1952-1966	H10-2	1	D3
SIDE COVER GASKET – ROLLS ROYCE/BENTLEY	1952-1966	UG808	1	D3
CONVERTER GASKET – OLDSMOBILE (14")	1942-1947	H1-2	1	D1
CONVERTER GASKET – CADILLAC (15")	1941-1948	H2-2	1	D1
CONVERTER GASKET (14")	1948-1966	H14-2	1	D1
FILTER				
FILTER SCREEN	1946-1951	H3-17	1	32
FILTER SCREEN, EXCEPT BELOW	1952-1959	H4-17	1	32
FILTER SCREEN, OLDSMOBILE	1954-1956	H5-17	1	32
FILTER SCREEN, GMC 450-650	1954-1957	H6-17	1	32
FILTER SCREEN, CHEVY TRUCK	1954-1959	H7-17	1	32
O-RINGS				
LEVER SEAL KIT - ALL	1946-1966	H105C	1	E1
CONVERTER O-RING 1953-1966 CHEVY/GMC PICK UP 1952-1956 HUDSON 1953-1956 NASH	1954-1966	H1-12	1	D1

SEALS				
FRONT PUMP SEAL	1942-1966	H9-9	1	A1
EXTENSION HOUSING SEAL 1946-1955 CADILLAC 1954-1966 CHEVY TRUCK (Ex. ½ TON) 1949-1954 LINCOLN 1952-1954 OLDSMOBILE	1946-1966	H2-9	1	C6 (3105H)
EXTENSION HOUSING SEAL 1951-1956 HUDSON 1952-1954 KAISER 1951-1956 NASH 1951-1955 PONTIAC 1953-1955 WILLYS 1954-1959 CHEVY/GMC TRUCK (1/2 TON)	1951-1956	H3-9	1	C6 (3146D)
EXTENSION HOUSING SEAL 1950 HUDSON 1949-1950 NASH 1946-1950 OLDSMOBILE 1946-1950 PONTIAC	1948-1950	H4-9	1	C6 (STEPPED SEAL)
EXTENSIONS HOUSING SEAL - OLDSMOBILE	1951	H5-9	1	C6
EXTENSION HOUSING SEAL - OLDSMOBILE	1955-1956	H7-9	1	C6 (STEPPED SEAL)
OLDSMOBILE DUST SHIELD	1955-1956	H30-10	1	NI
EXTENSION HOUSING SEAL – ROLLS/BENTLEY	1952-1966	472070	1	C6
HILL BRAKE SEAL – ROLLS/BENTLEY	1952-1966	472164	1	NI
BANDS				
REAR BRAKE BAND	1946-1951	H122	1	B15
REAR BRAKE BAND	1952-1966	H122A	1	B15
FRONT BRAKE BAND 1953-1956 OLDSMOBILE 1955-1956 PONTIAC	1953-1956	H122B	1	B2
FRONT BRAKE BAND 1946-1955 CADILLAC 1950-1954 KAISER 1946-1953 OLDSMOBILE 1948-1954 PONTIAC 1954-1961 CHEVY/GMC TRUCK 1950-1956 HUDSON	1946-1961	H122C	1	B2
FRONT BRAKE BAND w/spring – GMC TRUCK	1954-1957	H122E	1	B2
FRICTIONS				
FRICTION PLATE – FIBER, WAVED (.098")	1946-1966	H1-1	12	B6
FRICTION PLATE – FIBER, FLAT (.098")	1955-1958	D1-1A	14-16	B6
FRICTION PLATE – BRONZE (.061")	1940-	H1-1B	AR	B6

STEELS				
STEEL PLATE (.070")	1946-1966	H2-1	12	B5
STEEL PLATE (.049")	1955-1958	H4-1	12	B5
BUSHINGS				
BUSHING KIT	1946-1966	KH106A	1	NI
WASHERS				
THRUST WASHER KIT	1946-1966	KH111	1	NI
SEALING RINGS				
SEALING RING KIT	1946-1966	H104A	1	NI
NEW HARD PARTS				
MAINSHAFT LOCK NUT WASHER	1946-1966	8613734	1	24
OIL DELIVERY SLEEVE (3.25" LONG)	1946-1966	H28	1	B11
CRANKSHAFT BEARING	1946-1966	7109	1	NI
OUTPUT BEARING, PONTIAC	1951-1956	106	1	C12
OUTPUT BEARING 1946-1955 CADILLAC 1948-1950 PONTIAC 1952-1956 OLDSMOBILE	1946-1956	107	1	C12
REBUILT/USED HARD PARTS				
FRONT PUMP ASSEMBLY	1946-1950	H01	1	1
FRONT PUMP ASSEMBLY	1951	H01A	1	1
FRONT PUMP ASSEMBLY – 1 SEALING RING	1952-1966	H01B	1	1
FRONT PUMP ASSEMBLY – 2 SEALING RING	1952-1966	H01C	1	1
FRONT RING GEAR	1946-1949	H13	1	2
FRONT RING GEAR – 54 TH	1950-1966	H13A	1	2
FRONT RING GEAR – 60 TH	1950-1966	H13B	1	2
FRONT PLANETARY, 12-1/4" / 3 PIN /16 TH	1950-1966	H10	1	6
FRONT PLANETARY, 12-1/4" / 3 PIN /16 TH	1946-1949	H10A	1	6
FRONT PLANETARY, 12" / 3 PIN /16 TH	1946-1949	H10B	1	6
FRONT PLANETARY, 12-1/4" / 4 PIN /12 TH	1950-1966	H10C	1	6
FRONT PLANETARY, 12" / 4 PIN /12 TH	1950-1966	H10D	1	6
FRONT PLANETARY, 12-1/4" / 6 PIN /12 TH	1946-	H10E	1	6
FRONT PLANETARY, 12-1/4" / 4 PIN /16 TH	1950-1966	H10F	1	6
FRONT PLANETARY, 12" / 4 PIN /16 TH	1950-1966	H10G	1	6
FRONT PLANETARY, 12" / 3 PIN /16 TH	1950-1966	H10H	1	6
FRONT CLUTCH DRUM – 6 PINS	1946-1966	H05	1	B23
FRONT CLUTCH DRUM – 3 PINS	1946-1966	H05A	1	B23
CLUTCH RELEASE SPRING, INNER	1946-1966	8609072	6-12	B3
CLUTCH RELEASE SPRING, OUTER	1946-1966	8609071	6-12	B4
FRONT CLUTCH PISTON – CAST #	1946-1966	CALL	1	7
FRONT CLUTCH PISTON HOUSING - 6 HOLE/27 TH	1946-1966	H05B	1	8
FRONT CLUTCH PISTON HOUSING – 3 HOLE/27 TH	1946-1966	H05C	1	8
FRONT CLUTCH PISTON HOUSING – 3 HOLE/27 TH	1952-1954	H05D	1	8

FRONT CLUTCH PISTON HOUSING – 3 HOLE/27 TH	1946-1966	H05E	1	8
FRONT CLUTCH PISTON HOUSING – 3 HOLE/30 TH	1955	H05F	1	8
FRONT CLUTCH PISTON HOUSING – 3 HOLE/30 TH	1946-1966	H05G	1	8
FRONT CLUTCH PISTON HOUSING – 3 HOLE/30 TH	1952-1954	H05H	1	8
OIL DELIVERY SLEEVE (3.00" LONG)	1946-1966	H28A	1	B11
OIL DELIVERY SLEEVE (3.25" LONG)	1946-1966	H28	1	B11
REAR CLUTCH PISTON HOUSING – 6 HOLE	1946-1966	H06B	1	9
REAR CLUTCH PISTON HOUSING – 3 HOLE	1946-1966	H06C	1	9
REAR CLUTCH PISTON HOUSING – 3 HOLE	1952-1954	H06D	1	9
REAR CLUTCH PISTON HOUSING – 3 HOLE	1955	H06E	1	9
REAR CLUTCH PISTON – CAST #	1946-1966	CALL	1	10
REAR CLUTCH DRUM – 6 PINS	1946-1966	H06	1	B24
REAR CLUTCH DRUM – 3 PINS	1946-1966	H06A	1	B24
REAR RING GEAR	1946-1951	H14D	1	12
REAR RING GEAR	1951-1966	H14C	1	12
REAR CLUTCH HUB	1946-1966	H59	1	13
REAR CLUTCH HUB	1946-1966	H59A	1	13
REAR CLUTCH HUB	1946-1966	H59B	1	13
MAINSHAFT/GEAR 18" X 41TH X 9 SPLINE	1946-1966	H25	1	14
MAINSHAFT/GEAR 17-1/2" X 41TH X 22 SPLINE	1946-1966	H25A	1	14
MAINSHAFT/GEAR 18" X 33TH X 9 SPLINE	1946-1966	H25C	1	14
OUTPUT SHAFT/PLANET	1946-1966	CALL	1	15
REAR SUN GEAR/FLANGE	1946-1966	H20	1	16
REAR PLANETARY, 3 PINION ROUND TOP	1946-1950	H11	1	17
REAR PLANETARY, 3 PINION TRIANGLE TOP	1946-1950	H11A	1	17
REAR PLANETARY, 3 PINION ROUND TOP	1951-1966	H11B	1	17
REVERSE CLUTCH SPRING RETAINER - 2 TAB	1951-1953	8611973	1	C9
REVERSE CLUTCH SPRING RETAINER - 4 TAB	1954-1956	8615316	1	C9
REVERSE CLUTCH RELEASE SPRING	1951-1953	8611972	1	C10
REVERSE CLUTCH RELEASE SPRING	1954-1956	8615314	1	C10
REVERSE INTERNAL GEAR	1946-1950	H14B	1	18
REVERSE INTERNAL GEAR	1951-1953	H14	1	18
REVERSE INTERNAL GEAR	1954-1966	H14A	1	18
REVERSE INTERNAL GEAR (ROLLS ROYCE/BENTLEY)	1952-1966	H14E	1	18
REVERSE CONE, ALUMINUM	1946-1966	H41B	1	19
REVERSE CONE, CAST IRON	1946-1966	H41C	1	19
REVERSE PISTON, ALUMINUM	1946-1966	H41	1	20
REVERSE PISTON, CAST IRON	1946-1966	H41A	1	20
EXTENSION HOUSING – CAST #	1946-1966	CALL	1	21
FLYWHEEL COVER	1946-1956	CALL	1	22
MAINSHAFT LOCK WASHER	1946-1966	8613734	1	24
DRIVEN TORUS	1946-1966	CALL	1	25
DRIVE TORUS	1946-1966	CALL	1	27
PRIMARY PUMP COVER - OLDSMOBILE	1941	CNR-5	1	28
PRIMARY PUMP COVER - CADILLAC	1946-1948	CNR-4	1	28
PRIMARY PUMP COVER	1946-1953	CNR-1	1	28
PRIMARY PUMP COVER (EX. 1955 Caddy)	1954-1955	CNR-2	1	28
PRIMARY PUMP COVER - CADILLAC	1955	CNR-6	1	28
PRIMARY PUMP COVER (O-RING TYPE)	1954-1966	CNR-7	1	28

TRANSMISSION CASE – CAST #	1946-1966	CALL	1	29
OIL PAN	1946-1966	CALL	1	30
SIDE COVER PAN	1946-1950	H48G	1	31
SIDE COVER PAN	1951	H48H	1	31
SIDE COVER PAN	1952-1956	H48I	1	31
SIDE COVER PAN – TRUCK w/SOLENOID HOLE	1952-1962	H48J	1	31
SIDE COVER PAN – ROLLS ROYCE/BENTLEY	1952-1966	H48K	1	31
GOVERNOR, CAST IRON #177	1946-1966	H32	1	33
GOVERNOR, CAST IRON #063	1946-1966	H32A	1	33
GOVERNOR, ALUMINUM #670, #212, #938	1946-1966	H32B	1	33
GOVERNOR, ALUMINUM #081	1946-1966	H32C	1	33
REAR PUMP ASSEMBLY	1946-1966	CALL	1	34
VALVE BODY	1946-1966	CALL	1	35
THROTTLE LEVER/SHAFT	1946-1954	8609591	1	36
THROTTLE LEVER/SHAFT	1952-1966	8617071	1	36
BELL HOUSING – CAST #	1946-1966	CALL	1	NI