

# BORG WARNER-3 BAND DESIGN (1950-1967)

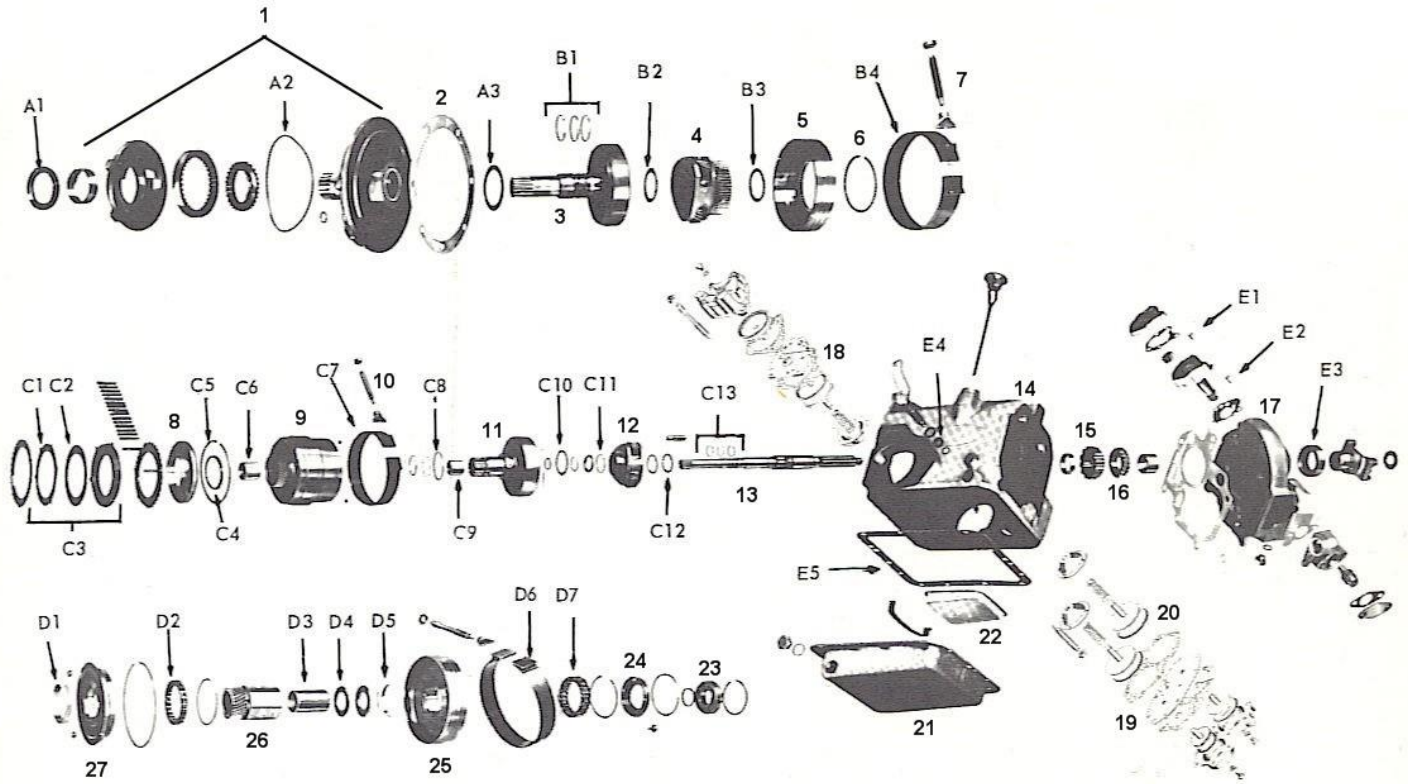

DESCRIPTION	YEAR	PART NUMBER	QTY	OE NUMBER
<b>KITS</b>				
MASTER KIT W/CLUTCHES & STEELS	1950-1966	DG102-1	1	
MAJOR KIT W/CLUTCHES	1950-1966	DG102-2	1	
OVERHAUL KIT	1950-1966	DG102-3	1	
<b>GASKETS</b>				
PAN GASKET	1950-1966	S1-2	1	E5
<b>FILTER</b>				
FILTER SCREEN - JAGUAR	1950-1966	S150	1	22
FILTER SCREEN - STUDEBAKER	1950-1966	S150B	1	22
<b>O-RINGS</b>				
BELLOWS SEAL (Int. Hold Solenoid)	1950-1966	S96	1	NI
<b>SEALS</b>				
FRONT PUMP SEAL	1950-1966	S2-9	1	A1
EXTENSION HOUSING SEAL	1950-1966	S3-9	1	E3 (3167Q)

LEVER SEAL	1950-1966	S1-9	1	E4
<b>BANDS</b>				
FORWARD BAND	1950-1966	S122R	1	D6
LOW BAND	1950-1966	S122R	1	C7
REVERSE BAND	1950-1966	S122A	1	B4
<b>FRICTIONS</b>				
FRICTION PLATE - FIBER (.097")	1950-1966	S1-1	3-4	C2
FRICTION PLATE - BRONZE (.060")	1950-1966	S1-1B	AR	C2
<b>STEELS</b>				
STEEL PLATE	1950-1966	S2-1	4-5	C1
<b>BUSHINGS</b>				
BUSHING KIT	1950-1966	KS106	1	NI
PUMP BUSHING	1950-1966	S9-6	1	
<b>WASHERS</b>				
THRUST WASHER KIT	1950-1966	KS111	1	NI
<b>SEALING RINGS</b>				
SEALING RING KIT	1950-1966	S104	1	NI
<b>SPRAGS</b>				
FORWARD SPRAG	1950-1966	S35	1	D7
FORWARD SPRAG	1950-1966	S35A	1	D7
REVERSE SPRAG	1950-1966	S35B	1	D2
REVERSE SPRAG	1950-1966	S35C	1	D2
<b>REBUILT/USED HARD PARTS</b>				
FRONT PUMP	1950-1966	S01	1	1
FRONT RING GEAR SHAFT	1950-1966	S13	1	3
FRONT RING GEAR SHAFT W/ID GROOVE	1950-1966	S13A	1	3
FRONT PLANETARY	1950-1966	S10	1	4
FRONT PLANETARY	1950-1966	S10A	1	4
REVERSE DRUM	1950-1966	S07	1	5
HIGH CLUTCH PISTON		S39	1	8
HIGH CLUTCH DRUM	1950-1966	S05	1	9
HIGHT CLUTCH DRUM	1950-1966	S05A	1	9
HIGH CLUTCH DRUM	1950-1966	S05B	1	9
HIGH CLUTCH PRESSURE PLATE	1950-1966	S44	1	
HIGH CLUTCH SPACER PLATE	1950-1966	S45	1	
REAR RING GEAR SHAFT	1950-1966	S14	1	11
REAR RING GEAR SHAFT W/ID GROOVE	1950-1966	S14A	1	11
REAR PLANETARY	1950-1966	S11	1	12

REAR PLANETARY	1950-1966	S11A	1	12
OUTPUT SHAFT w/ external threads	1950-1966	S52	1	13
OUTPUT SHAFT w/internal threads	1950-1966	S52A	1	13
SPRAG RACE (OUTER) w/snap ring groove	1950-1966	S46	1	27
SPRAG RACE (OUTER) (2 notch)	1950-1966	S46A	1	27
SUN GEAR	1950-1966	S20	1	26
FORWARD DRUM	1950-1966	S06	1	25
SERVO ASSEMBLY	1950-1966	CALL	1	18
SERVO ASSEMBLY	1950-1966	CALL	1	19
SERVO ASSEMBLY	1950-1966	CALL	1	20
REAR PUMP ASSEMBLY	1950-1966	S60	1	E2
GOVERNOR ASSEMBLY	1950-1966	S32	1	NI
GOVERNOR SHAFT	1950-1966	S34	1	
TRANSMISSION CASE	1950-1966	CALL	1	14
PARK GEAR – 6 SPLINE	1950-1966	S47	1	15
PARK GEAR – 10 SPLINE	1950-1966	S47A	1	15
GOVERNOR DRIVE GEAR	1950-1966	CALL	1	16
TRANSMISSION PAN w/large hole tube	1950-1966	S48	1	21
TRANSMISSION PAN w/small hole tube	1950-1966	S48A	1	21
TRANSMISSION PAN w/o filler hole	1950-1966	S48B	1	21
EXTENSION HOUSING	1950-1966	CALL	1	17
REAR PUMP	1950-1966	S60	1	
REAR PUMP	1950-1966	S60A	1	
OUTPUT BEARING	1950-1966	206L	1	23
PARKING PAWL	1950-1966	S62	1	NI
BELL HOUSING	1950-1966	CALL	1	NI
VALVE BODY	1950-1966	CALL	1	NI
CONVERTER TRANSFER TUBE	1950-1966	S109K	1	NI
<b>TORQUE CONVERTER</b>				
STUDEBAKER CONVERTER	1950-1966	S1	1	NI
JAGUAR CONVERTER	1950-1966	JA1	1	NI
MERCEDES CONVERTER	1950-1966	CNR-30	1	NI