

# ALUMINUM CASE POWERGLIDE (1962-1973)

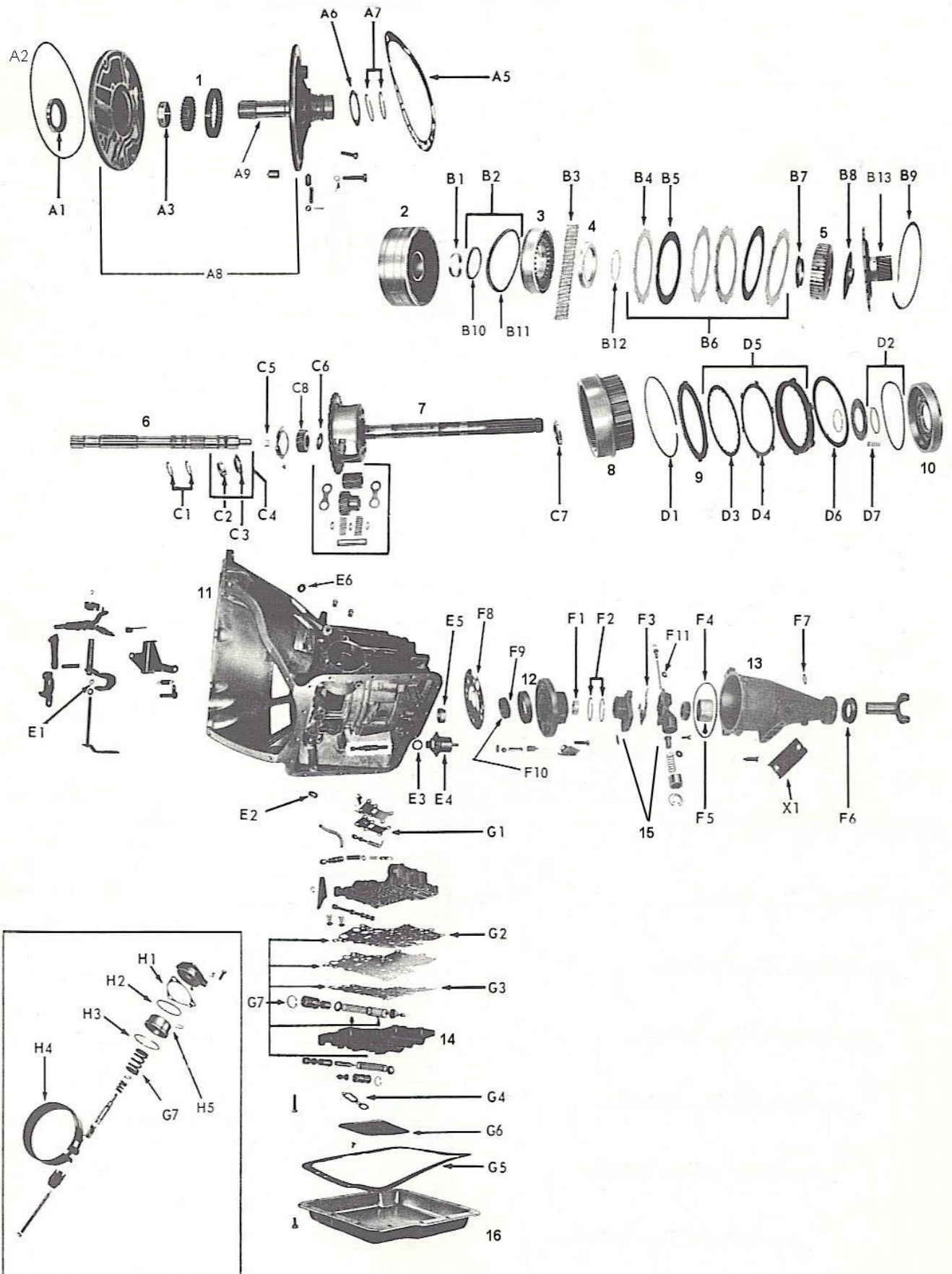

**ALUMINUM POWERGLIDE**

ILL	DESCRIPTION	YEARS	QTY	FATSCO	REFERENCE
<b>REBUILDING KITS</b>					
DESCRIPTION	YEARS	MASTER KIT	MAJOR KIT	OVERHAUL KIT	PAPER/RUBBER
Aluminum Powerglide .....	62-73	114-CX	214-CX	303-CX	518-CX
<b>HI-PERFORMANCE</b>					
Alum. PG - standard steels	62-73	1500-CX	2500-CX	3635-CX	
Alum. PG - Kolene® steels	62-73	1501-CX	2500-CX	3635-CX	
<b>VALVE BODY KITS</b>					
NI	Shift Kit® .....	62-73	1	SFK-PG2S	SK®PG-2S
<b>CLUTCH PLATES</b>					
<b>FRICION PLATES</b>					
B5	High - .098" .....	62-73	5	1282-E	1373575
	- .098" - hi-performance - red .....	62-73	5	1621-C	
	- .098" - hi-performance - bronze .....	62-63	5	1936-C	
	- .061" - hi-performance .....	62-73	ar	1622-C	
	- .061" - hi-performance - blue.....	62-73	ar	R114106AHP	
D3	Reverse - .098" .....	62-73	5	1324-T	1375558
	- .098" - hi-performance .....	62-73	5	1639-BC	
<b>STEEL PLATES</b>					
B4	High - .070" .....	62-73	5-6	1195-C	1361925
	- .060" .....	62-73	ar	1243-C	
	- .060" - Kolene .....	62-73	ar	114126BK	
	- .050" .....	62-73	ar	1284-G	
	- .090" .....	62-73	ar	1244-G	
	- .040" .....	62-73	ar	1283-G	
	- .070" - Kolene® .....	62-73	5	1623-C	
D4	Reverse - .070" .....	62-73	5-6	1197-C	1379373
	- .102" .....	62-73	ar	1198-C	
	- .134" .....	62-73	ar	1199-C	
	- .070" - Kolene® .....	62-73	5	1624-C	
<b>CLUTCH PACKS</b>					
NI	High Clutch Powerpack™ .....	62-73	1	19755HP	
<b>GASKETS</b>					
G5	Oil Pan - fiber .....	62-73	1	2362-C	3789148
	- cork & rubber .....	62-73	1	2362-CCR	3789148
A5	Front Pump to Case .....	62-73	1	2365-C	3789022
E3	Vacuum Modulator .....	62-73	1	2361-V	6257218
F3	Governor - 1st design .....	1962	1	2370-C	3789047
F3	- 2nd design .....	62-73	1	2371-C	3818935
F8	Governor Supt Body (62-66 does not use gasket)	67-73	1	2576-C	3890524

	Upper Valve Body Plate .....	62-73	1	<b>2507-C</b>	3840329
	Valve Body Transfer Plate - upper .....	62-66	1	<b>2505-C</b>	3840330
	Valve Body Transfer Plate - lower .....	62-66	1	<b>2506-C</b>	3840331
	Valve Body Transfer Plate - upper & lower .....	67-73	2	<b>2560-C</b>	7420925
G4	Oil Screen .....	62-73	1	<b>2364-C</b>	3795990
H1	Servo Cover .....	62-73	1	<b>2366-C</b>	3789086

### O'RINGS & RUBBER SEALS

A2	LCS, Front Pump to Case .....	62-73	1	<b>4655-C</b>	3789013
	O'ring, Front Pump Bolt .....	62-65	7	<b>4626-C</b>	3789024
	Washer Seal, Front Pump Bolt .....	65-73	7	<b>9270-C</b>	3884683
	Seal, Throttle Valve Shaft .....	62-73	1	<b>4596-T</b>	3727391
	O'ring, Oil Filler Tube .....	62-73	1	<b>4702-BC</b>	6255641
F4	Seal, Rear Pump Body (External Housing) .....	62-73	1	<b>4659-C</b>	3789056
	Seal, Speedometer Gear .....	62-73	1	<b>4583-G</b>	3708146
	Seal, Servo Cover .....	62-73	1	<b>4660-C</b>	3789087
<b>CLUTCH PISTON SEALS</b>					
B10	Lip Seal, High Clutch - inner .....	63-73	1	<b>4095-C</b>	3826034
B10	Lip Seal, High Clutch - inner .....	62-63	1	<b>4094-C</b>	3812833
B11	Lip Seal, High Clutch - outer .....	62-73	1	<b>4131-E</b>	1362832
	LCS, Reverse Clutch - inner .....	62-73	1	<b>4541-V</b>	3812830
	LCS, Reverse Clutch - outer .....	62-73	1	<b>4658-C</b>	3812832

### METAL CLAD SEALS

A1	Front Pump .....	62-73	1	<b>3178-E</b>	8626916
	Manual Control Valve .....	62-73	1	<b>3161-C</b>	3789137
F6	Extension Housing - w/flange .....	62-73	1	<b>3146-D</b>	1243402
	- w/o flange .....	62-73	opt	<b>3147-G</b>	1386231
	- rubber coated .....	62-73	opt	<b>3115-G</b>	1386231

### BUSHINGS

NI	Bushing Kit .....	62-73	1	<b>5041-CX</b>	
A3	Front Pump Body - babbitt .....	62-73	1	<b>5295-L</b>	8623940
B1	Clutch Drum - standard .....	62-73	1	<b>5282-C</b>	3840760
	- wide .....	62-73	1	<b>5118-D</b>	
C5	Output Shaft Pilot - standard .....	62-73	1	<b>5146-G</b>	3789034
	- bronze - oversize length .....	62-73	ar	<b>5277-BC</b>	
	- undersized ID .....	62-73	ar	<b>5381-BC</b>	
E5	Case .....	62-73	1	<b>5231-C</b>	3789009
F1	Rear Pump Body .....	62-73	1	<b>5234-C</b>	3789877
F5	Extension Housing - babbitt .....	62-73	1	<b>5148-G</b>	3717682
	- bronze .....	62-73	1	<b>5334-BC</b>	6260048
	Sun Gear Bushing - internal splines .....	62-73	1	<b>8436</b>	

### WASHERS, BEARINGS, RACES & SHIMS

<b>KITS</b>					
NI	Washer Kit - selective .....	62-73	1	<b>6064-GX</b>	
NI	Washer & Bushing Kit - low sun gear .....	62-73	1	<b>6037-GX</b>	3758781
<b>WASHERS &amp; SHIMS</b>					
NI	Low Sun Gear to Input Sun Gear .....	62-73	1	<b>6293-G</b>	3755412

GENERAL MOTORS

# ALUMINUM POWERGLIDE

ILL	DESCRIPTION	YEARS	QTY	FATSCO	REFERENCE
A6	Clutch Drum - .061" .....	62-73	ar	<b>6495-G</b>	3845835
A6	- .078" .....	62-73	ar	<b>6496-G</b>	3845836
A6	- .093" .....	62-73	ar	<b>6497-G</b>	3845837
A6	- .106" .....	62-73	ar	<b>6498-G</b>	3845838
B7	Clutch Drum to Hub		1	<b>3783285</b>	
B8	Clutch Hub to Sun Gear Flange		1	<b>PG12-11B</b>	
17	Low Sun Gear to Input Sun Gear, 1-11/16" OD		1	<b>6462C</b>	.041" thick
17	Low Sun Gear to Input Sun Gear, 1-1/2" OD		1	<b>PG24-11</b>	.041" thick
C6	Input Sun Gear to Planetary .....	62-73	1	<b>PG26-11</b>	3689834
NI	Planetary Pinion .....	62-73	6	<b>6300-G</b>	3790777
<b>BEARINGS &amp; RACES</b>					
C7	Output Shaft to Case .....	62-73	1	<b>6439C</b>	
17	Low Sun Gear to Input Sun Gear, 1-5/8" OD.....	62-73	1	<b>6547C</b>	3771838
<b>SEALING RINGS</b>					
NI	Sealing Ring Kit .....	62-73	1	<b>7051-CX</b>	
A7	Clutch Drum .....	62-73	2	<b>7209-G</b>	3689808
C1	Input Shaft .....	62-73	2	<b>7237-C</b>	3817715
F2	Governor - metal .....	62-73	2	<b>7209-G</b>	3689808
	Governor Support - teflon .....	71-73	1	<b>7320-C</b>	3987944
	Low Servo - aluminum .....	62-73	1	<b>7243-C</b>	3789084
<b>FILTERS</b>					
G6	Filter .....	62-73	1	<b>801-C</b>	3849968
	Filter Kit .....	62-73	1	<b>701-CX</b>	6438815
<b>BANDS</b>					
H4	Low Brake Band .....	62-73	1	<b>BT-17</b>	3883918
<b>MODULATORS</b>					
E4	Modulator - 6 cyl. ....	64-69	1	<b>MT-57</b>	5638206
	- 2nd design - 8 cyl. ....	63-73	1	<b>MT-58</b>	5638205
	- 1st design - 8 cyl. – Large Threads ..	62-63	1	<b>MT-55</b>	3812741
	- adjustable .....	63-73	1	<b>MT-59</b>	
<b>HARD PARTS - NEW</b>					
<b>PUMP PARTS</b>					
1	Front Pump Gear Set .....	62-73	1	<b>8137-G</b>	
<b>SPRINGS</b>					
B3	High Clutch Piston .....	62-73	24	<b>17509-C</b>	3783288
D7	Reverse Clutch Piston .....	62-73	17	<b>17510-C</b>	3789061
<b>ELECTRICAL COMPONENTS</b>					
	Smog Control Switch - 3 prong .....	72-73	1	<b>8583-BC</b>	3996287
	- 2 prong .....	70-73	1	<b>8580-BC</b>	6462549
	- 1 prong .....	70-71	1	<b>8581-BC</b>	6462514

## HARD PARTS

A8	Front Pump – air cooled	62-73	1	<b>PG01</b>
A8	Front Pump – water cooled	62-73	1	<b>PG01</b>
2	High Clutch Drum	62-63	1	<b>PG06</b>
2	High Clutch Drum	63-73	1	<b>PG06A</b>
3	High Clutch Piston – 3783283	62-63	1	<b>PG39</b>
3	High Clutch Piston – 3792700	62-63	1	<b>PG39A</b>
3	High Clutch Piston – 3844206	63-73	1	<b>PG39B</b>
3	High Clutch Piston – 3844205	63-73	1	<b>PG39C</b>
3	High Clutch Piston – 3826032	63-73	1	<b>PG39D</b>
3	High Clutch Piston – 3826033	63-73	1	<b>PG39E</b>
3	High Clutch Piston – 3826045	63-73	1	<b>PG39F</b>
3	High Clutch Piston – 3883902	63-73	1	<b>PG39G</b>
3	High Clutch Piston – 3826046	63-73	1	<b>PG39H</b>
3	High Clutch Piston - 3844181	63-73	1	<b>PG39I</b>
5	High Clutch Hub – 15/16" tall	62-73	1	<b>PG59</b>
5	High Clutch Hub – 1-1/8" tall	62-73	1	<b>PG59A</b>
7	Planetary – 14-3/4", 1:76 ratio, fine spline	62-73	1	<b>PG11</b>
7	Planetary – 12-1/2", 1:76 ratio, fine spline	62-73	1	<b>PG11A</b>
7	Planetary – 14-3/4", 1:82 ratio, coarse spline	62-73	1	<b>PG11B</b>
7	Planetary – 12-1/2", 1:76 ratio, coarse spline	62-63	1	<b>PG11C</b>
7	Planetary – 14-3/4", 1:82 ratio, fine spline	62-73	1	<b>PG11D</b>
7	Planetary – 14-3/4", 1:76 ratio, coarse spline	62-73	1	<b>PG11E</b>
7	Planetary – 14-3/4", 1:76 ratio, fine spline	67-73	1	<b>PG11F</b>
7	Planetary – 21", 1:76 ratio, fine spline	62-73	1	<b>PG11G</b>
8	Planetary Ring Gear – 1:76 / 94th	62-73	1	<b>PG14</b>
8	Planetary Ring Gear – 1:82 / 79th	62-73	1	<b>PG14A</b>
8	Planetary Ring Gear – 1:76 use w/pg11c/pg11e	62-73	1	<b>PT14</b>
B13	Sun Gear Flange – 1:76	62-73	1	<b>PG20</b>
B13	Sun Gear Flange – 1:82	62-73	1	<b>PG20A</b>
B13	Sun Gear Flange – 1:76	62-73	1	<b>PG20B</b>
B13	Sun Gear Flange – 1:76	62-73	1	<b>PG20C</b>
6	Input Shaft – 12-5/8"	62-73	1	<b>PG25</b>
6	Input Shaft - 12-5/8"	62-73	1	<b>PG25A</b>
6	Input Shaft – 12-7/8"	62-73	1	<b>PG25B</b>
6	Input Shaft - 12-7/8"	62-73	1	<b>PG25C</b>
6	Input Shaft - 12-5/8"	62-73	1	<b>PG25D</b>
6	Input Shaft - 12-7/8"	62-73	1	<b>PG25E</b>
15	Governor	62-73	1	<b>PG32</b>
	Valve Body w/rear pump	62-66	1	<b>PG33</b>
	Valve Body w/o rear pump	67-73	1	<b>PG33A</b>
10	Reverse Piston – 3790166	62-73	1	<b>PG41</b>
10	Reverse Piston - 3789058	62-73	1	<b>PG41A</b>
10	Reverse Piston – 3845855	62-73	1	<b>PG41B</b>
10	Reverse Piston – 3845856	62-73	1	<b>PG41C</b>
10	Reverse Piston – 3845857	62-73	1	<b>PG41D</b>

**GENERAL MOTORS****ALUMINUM POWERGLIDE**

<b>ILL</b>	<b>DESCRIPTION</b>	<b>YEARS</b>	<b>QTY</b>	<b>FATSCO</b>	<b>REFERENCE</b>
10	Reverse Piston – 3974411	62-73	1	<b>PG41E</b>	
10	Reverse Piston - 3823410	62-73	1	<b>PG41F</b>	
F8	Rear Pump Plate	62-66	1	<b>PG43</b>	
9	Reverse Pressure Plate .314"	62-73	1	<b>PG44</b>	
9	Reverse Pressure Plate .351"	62-73	1	<b>PG44A</b>	
9	Reverse Pressure Plate .386"	62-73	1	<b>PG44B</b>	
16	Transmission Pan	62-73	1	<b>PG48</b>	
11	Transmission Case	62-73	1	<b>CALL</b>	
12	Rear Pump Assembly	62-66	1	<b>PG60</b>	
12	Output Support	67-73	1	<b>PG60A</b>	
13	Extension Housing – 9" w/o shifter bosses	67-73	1	<b>PG37</b>	
13	Extension Housing – 9" w/shifter bosses	67-73	1	<b>PG37A</b>	
13	Extension Housing – 11" w/o shifter bosses	67-73	1	<b>PG37B</b>	
13	Extension Housing – 11" w/shifter bosses	67-73	1	<b>PG37C</b>	
13	Extension Housing – Van, top mount	67-73	1	<b>PG37D</b>	
13	Extension Housing – Vega w/counterweight	67-73	1	<b>PG37E</b>	
16	Transmission Oil Pan	67-73	1	<b>PG48</b>	
	Servo Piston Assembly	67-73	1	<b>Call</b>	

